

BELAZ - 7513 mining dump truck chassis loading scheme

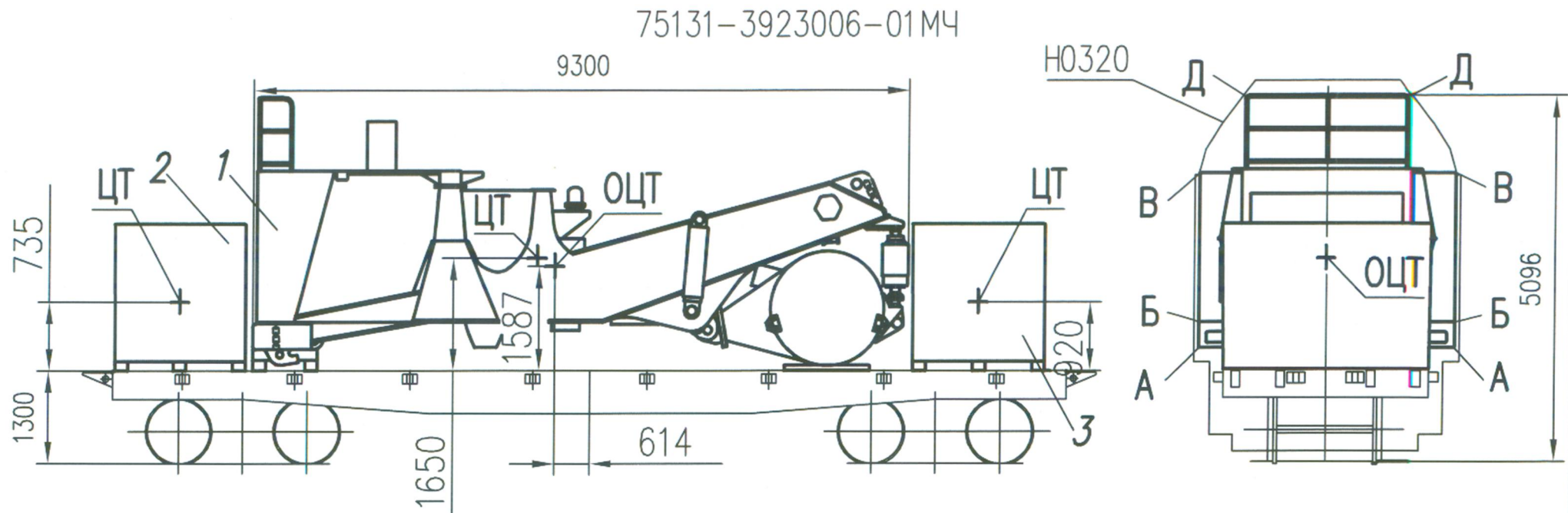

- 1. chassis M=32000 kg, 9300x3570x3780 mm
- 2. box with power cabinet M=1780 kg, 2880x1900x1720 mm
- 3. box with cabin M=2130 kg, 2240x2100x2500 mm
- Fasteners 300 kg
- Total weight 36210

Size overage H 0320

Chart of critical points of load

Point	Distance from waggon longitudinal axis	Height from level rails head top	Level of size overage
A	1825	1600	3 side
Б	1825	1960	3 side
В	1790	4030	2 overhead
Д	1170	5096	2 overhead

BELAZ - 7515 body loading scheme

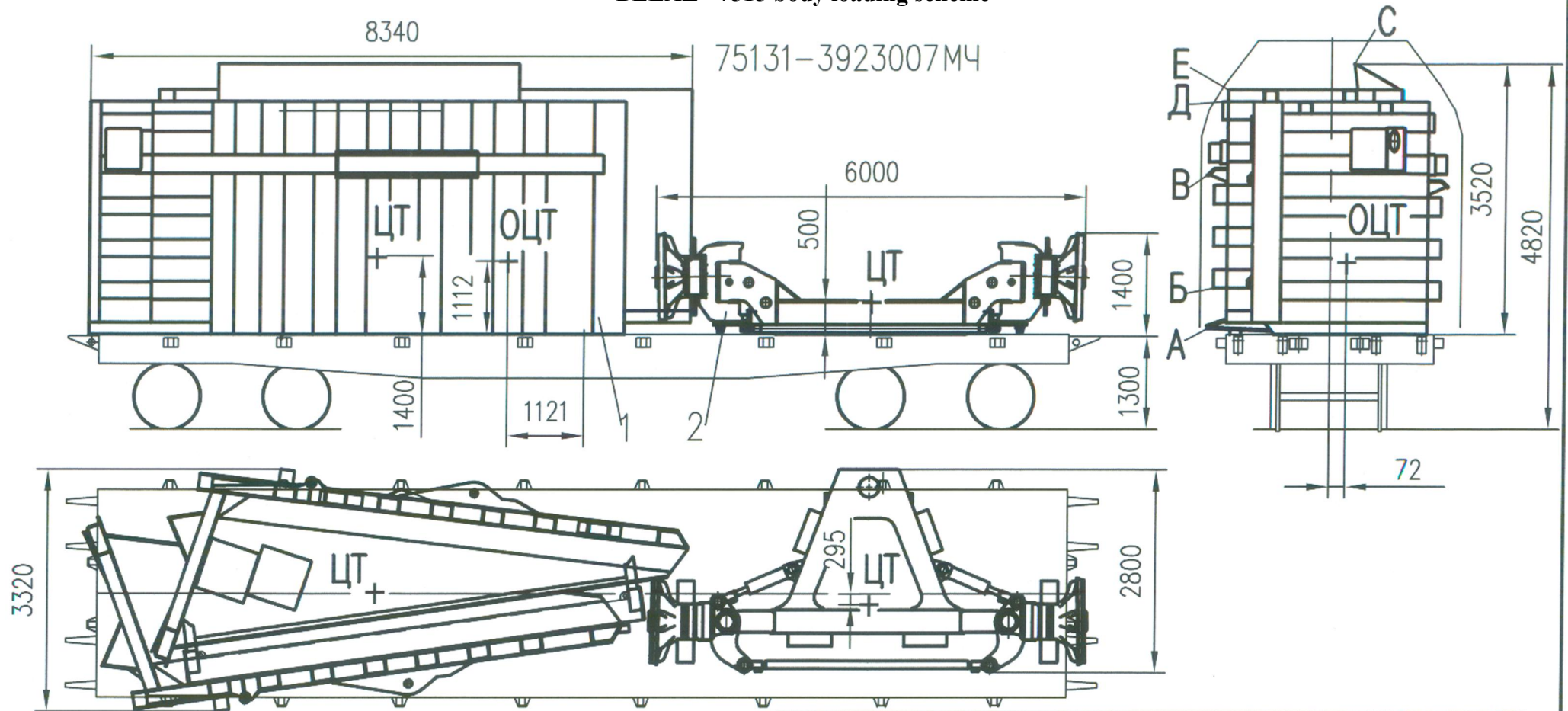

- 1. body component M=26600 kg
- 2. front axle M=8800 kg
- Fasteners M=200 kg
- Total weight: M=35600 kg
- Size overage H 2220

Point	Distance from waggon longitudinal axis	Height from level of rails head top	Level of size overage
A	1720	1360	2 base
Б	1625	1930	overall dimensions
В	1710	3462	2 side
Д	1515	4460	2 overhead
Е	1430	4620	2 overhead
С	600	4820	overall dimensions

Loading scheme of assembly parts of BELAZ - 7513 mining dump truck

75135-3923008M4

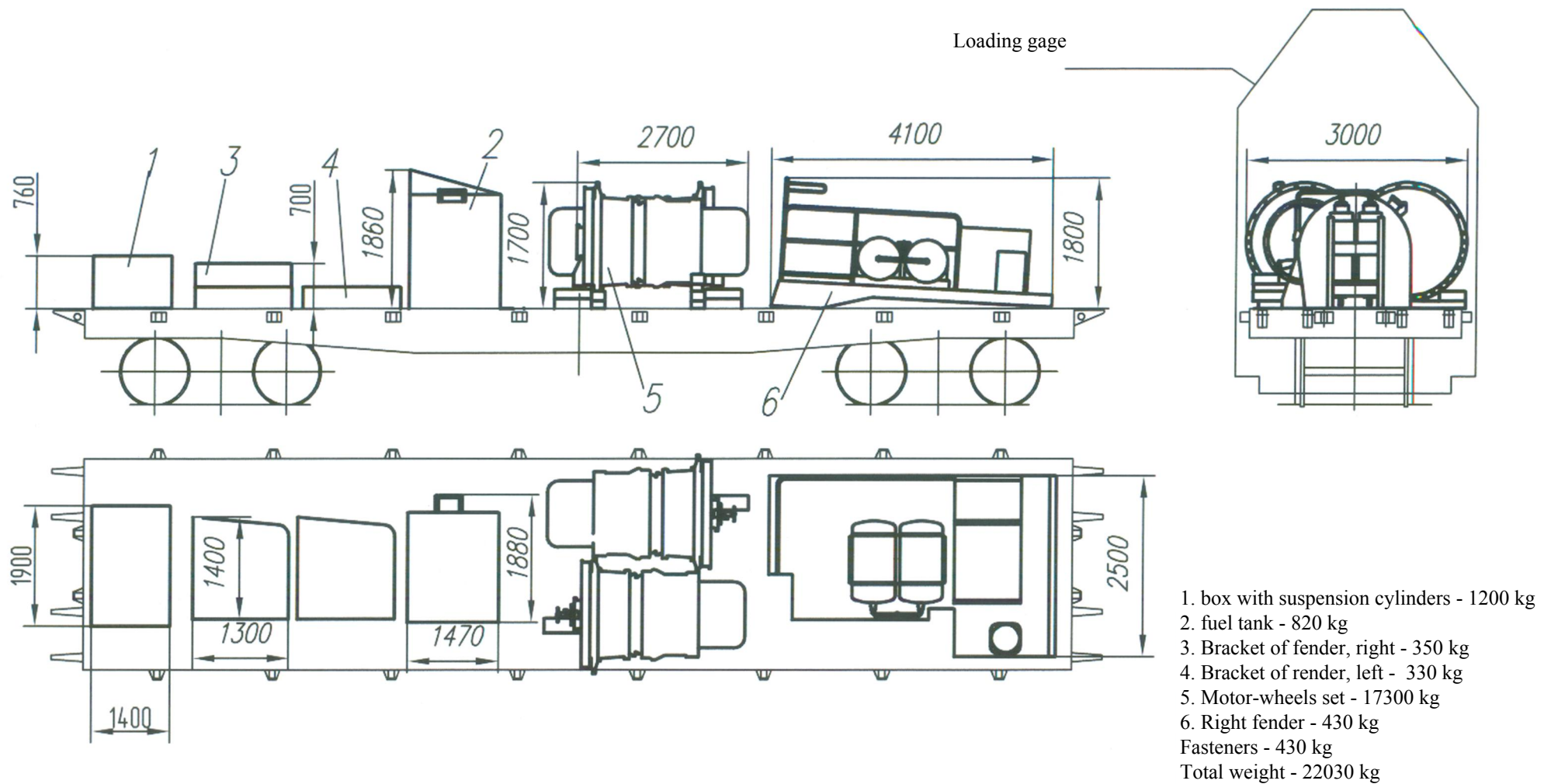

Loading scheme of seven wheels of BELAZ - 7513 mining dump truck

7513-3923009M4

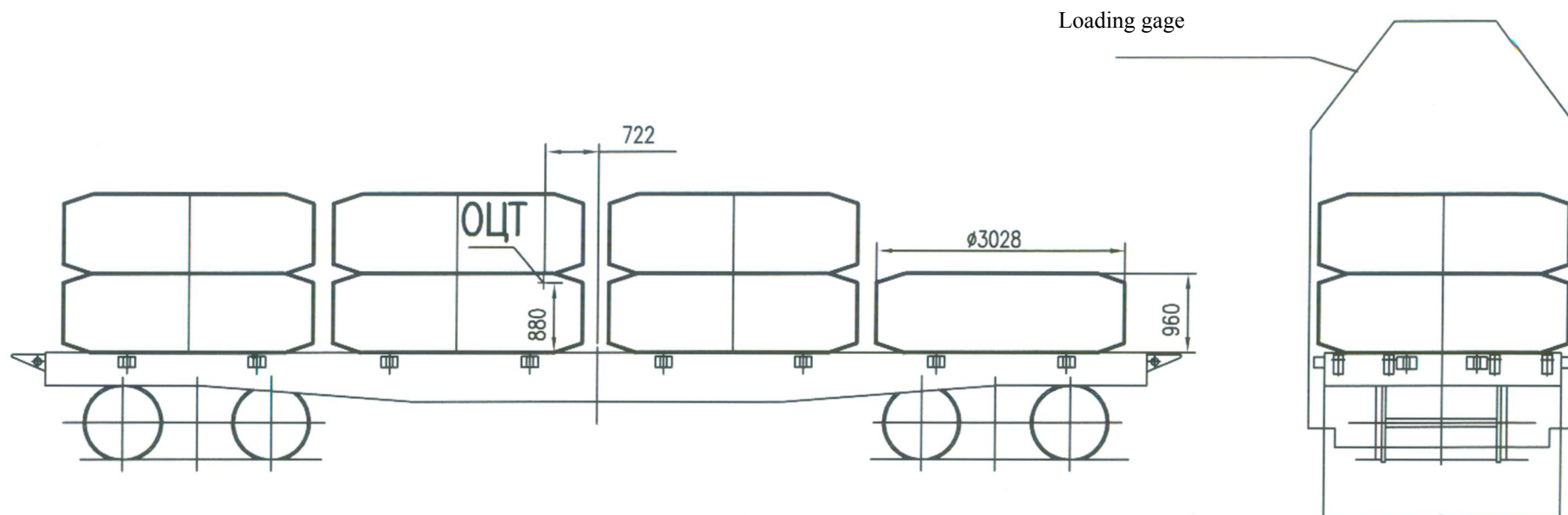

Wheel - 3100 kg
Fasteners - 200 kg
Total weight: 21900 kg