

X:\1406_FirefightersMuseum\2Work\04Draw\SKAbase_1406.dwg 09/30/14

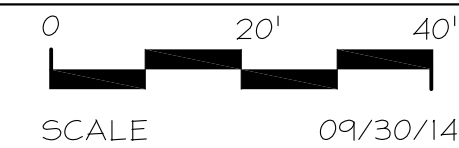
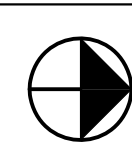
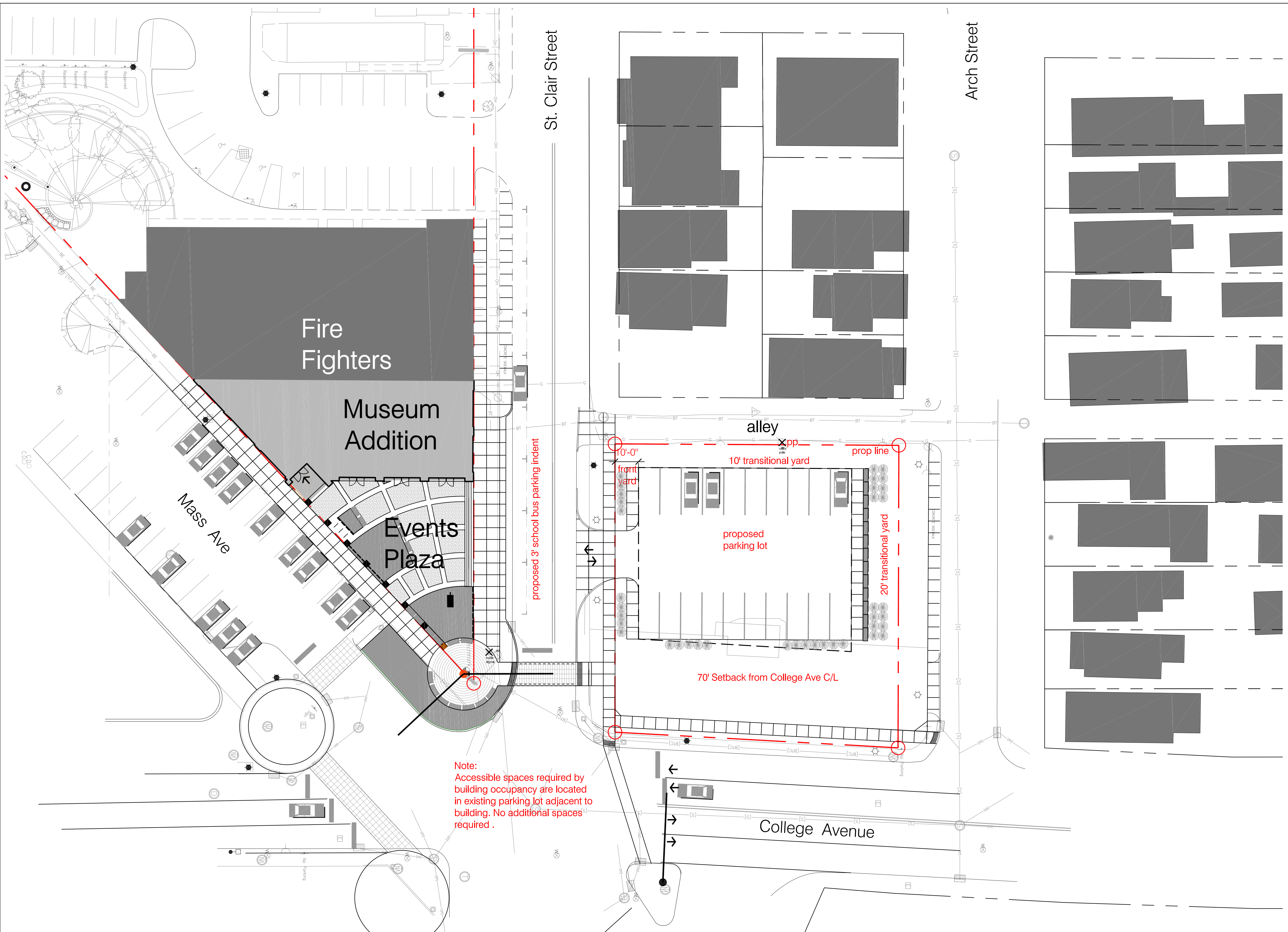

Firefighters Parking Court & St. Clair Improvements
Mass Ave | Chatham Arch Historic District

CONTEXT PLAN

L1

X:\1406_FirefightersMuseum\2Work\04Draw\SKAbase_1406.dwg 09/30/14

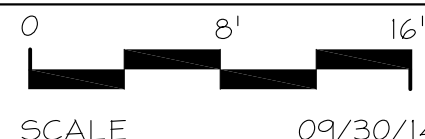
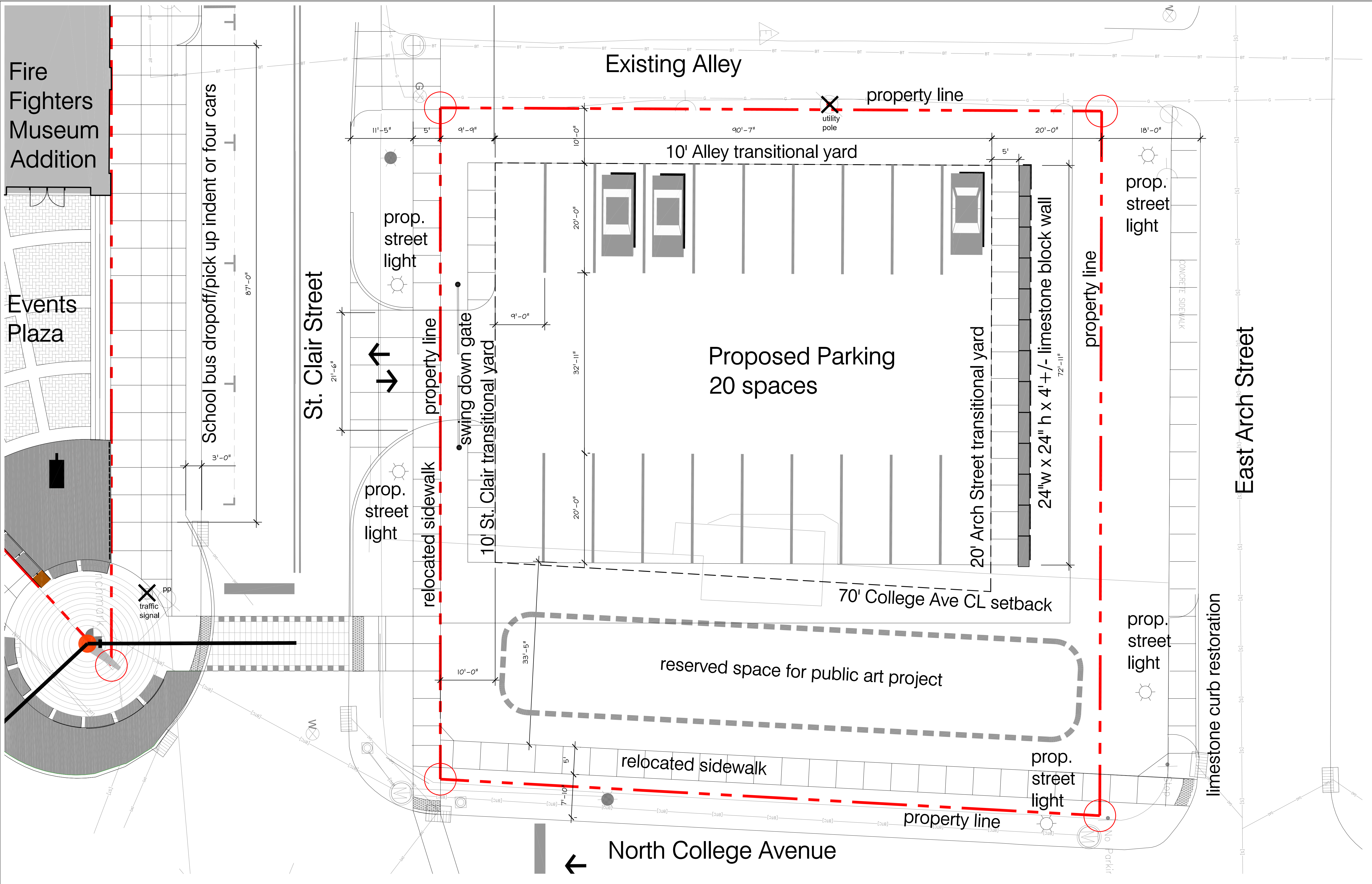

Firefighters Parking Court & St. Clair Improvements
Mass Ave | Chatham Arch Historic District

LAYOUT
PLAN

L2

X:\1406_FirefightersMuseum\2Work\04Draw\SKAbase_1406.dwg 09/30/14

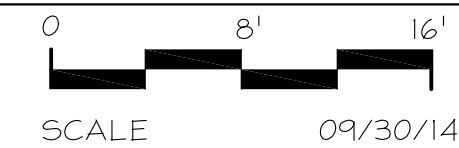
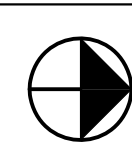
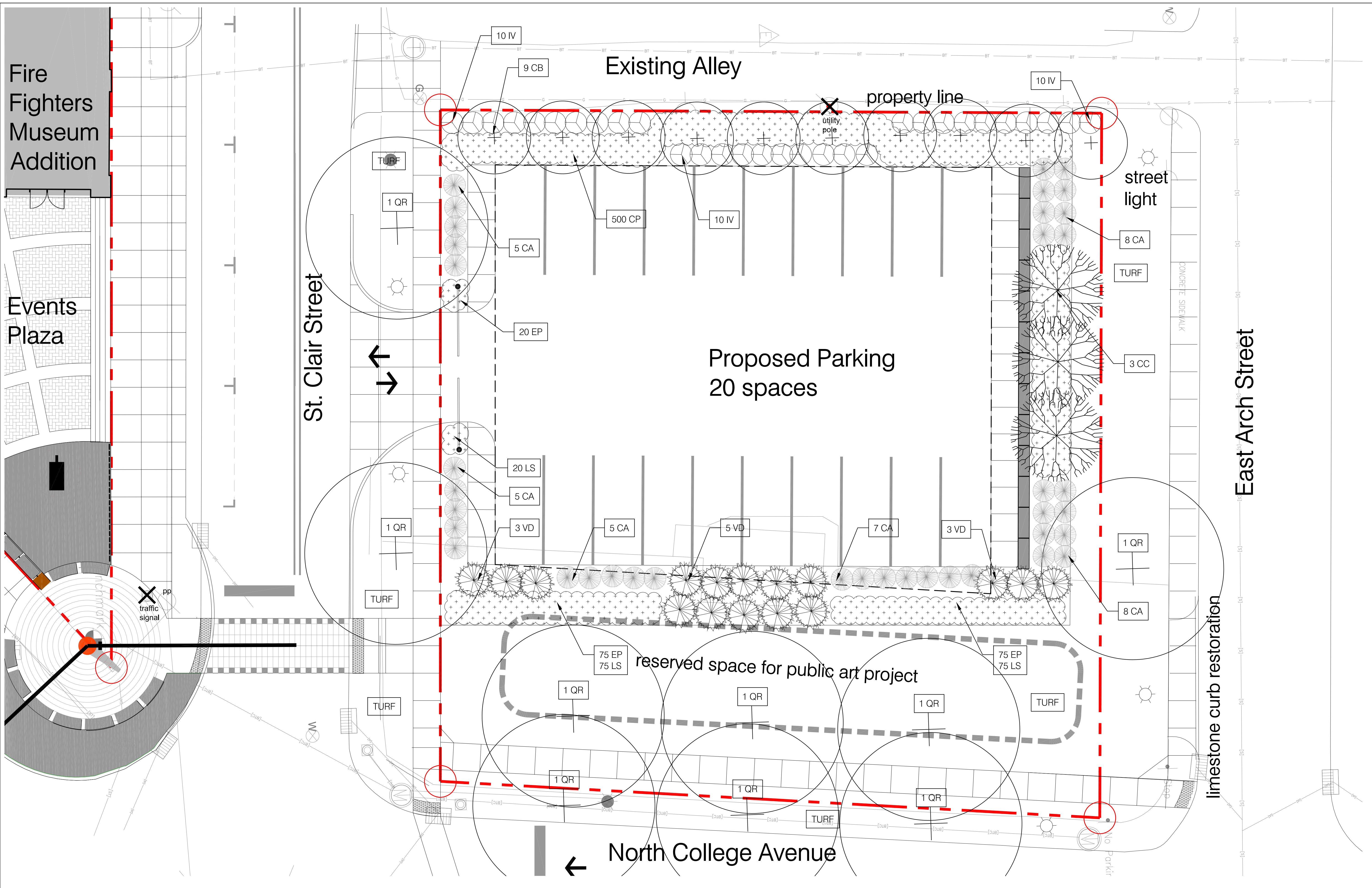

Firefighters Parking Court & St. Clair Improvements
Mass Ave | Chatham Arch Historic District

PLANTING
PLAN

L3

09/30/14 04Draw\04Draw\SKA_PlantingDetails_1406.dwg 09/30/14 04Draw\04Draw\SKA_PlantingDetails_1406.dwg

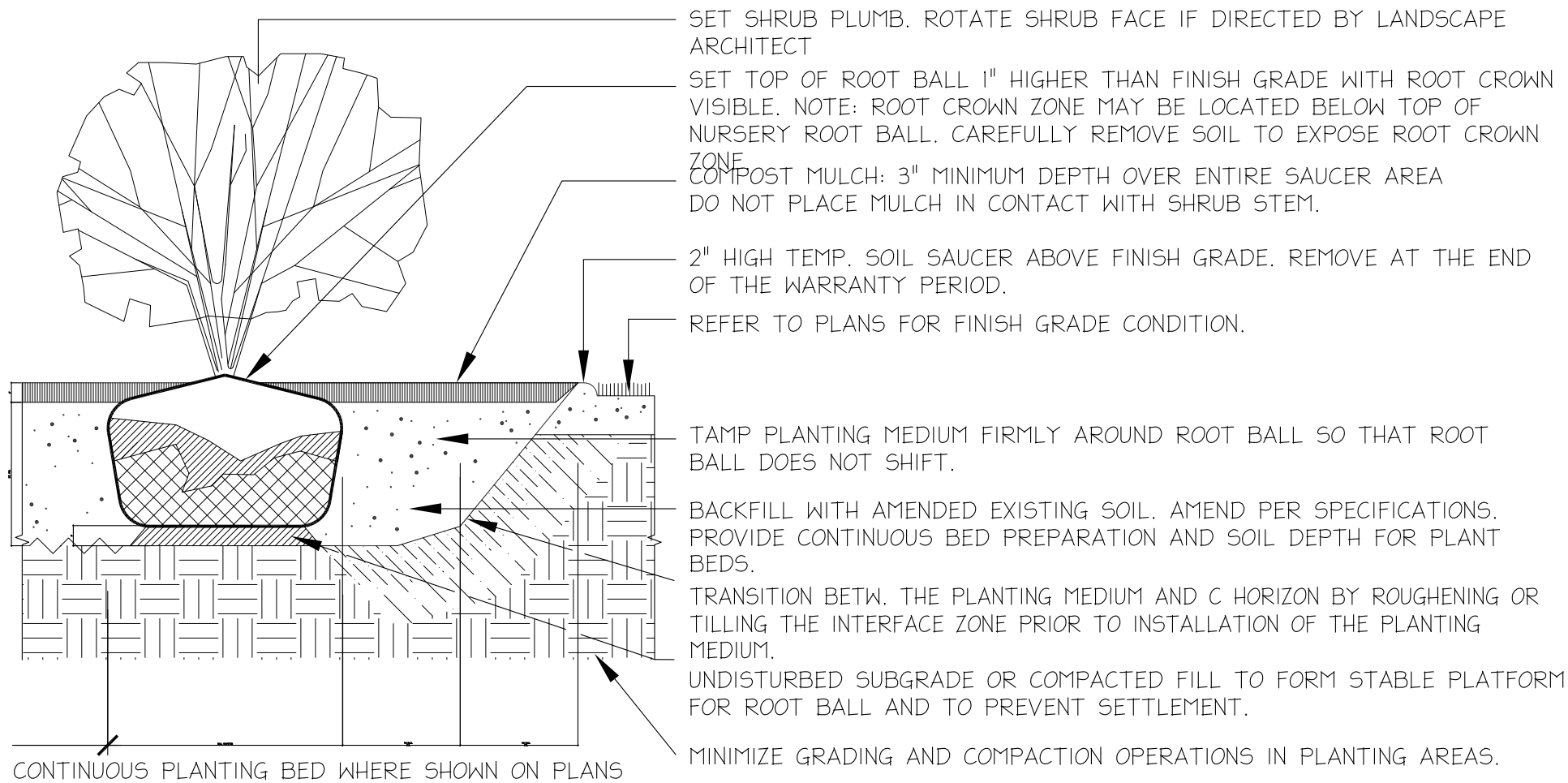

1 Shrub Planting Detail

1/4" = 1'-0"

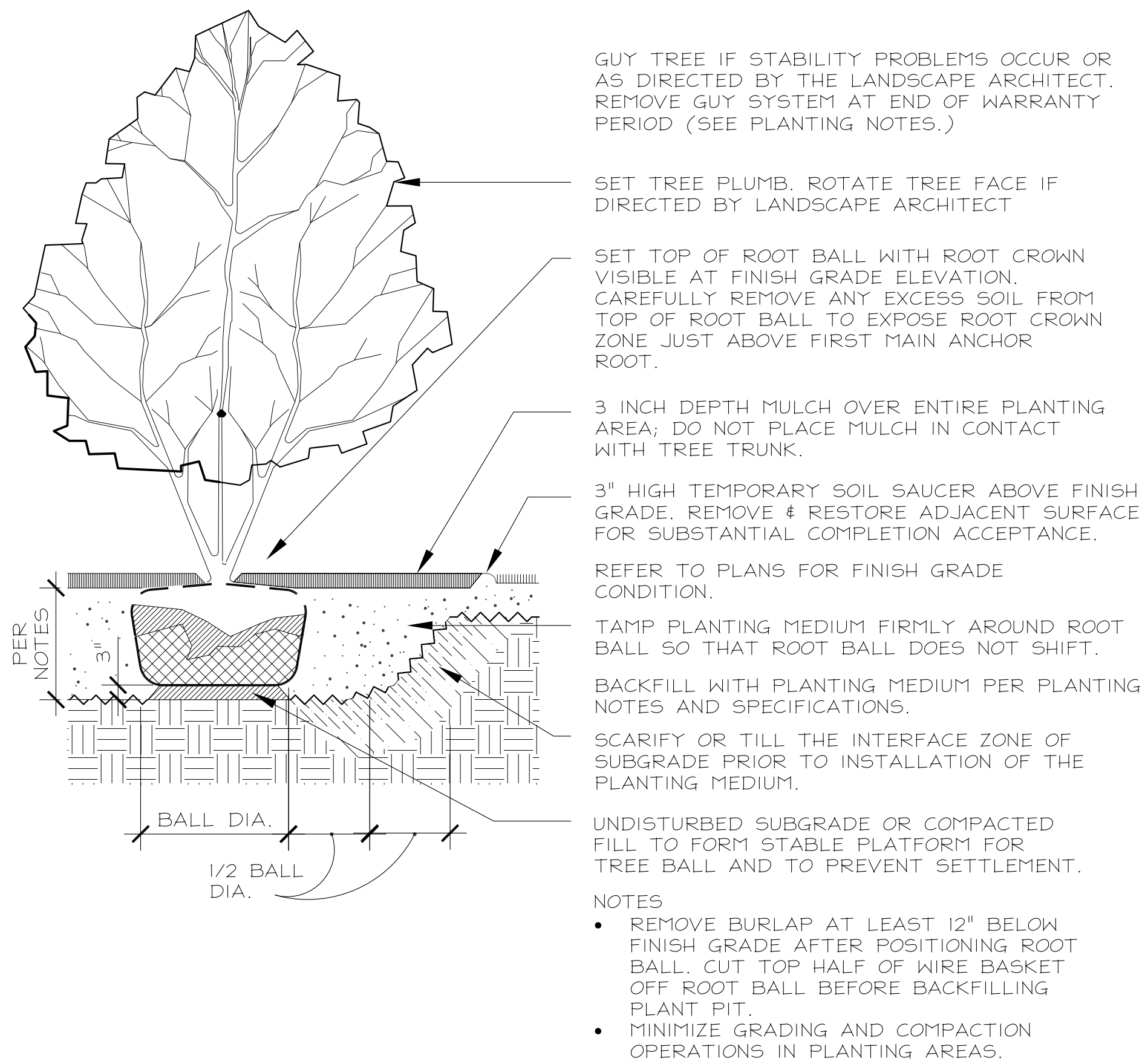

3 Tree Planting Detail

1/2" = 1'-0"

QTY	KEY	BOTANICAL NAME	COMMON NAME	SIZE	ROOT	NOTES
TREES						
3	CC	Cercis canadensis	Eastern Redbud	10-12' ht	B&B	1.25" min. stem cal. Clump - min. 3 stems, max. 5 stems.
10	CB	Carpinus betulus 'Fastigita'	Pyramidal Eurpean Hornbeam	2.5" cal	B&B	Straight trunk, full crown, branching to start at 7 feet
9	QR	Quercus rubra	Red Oak	2.5" cal	B&B	Straight trunk, full crown, branching to start at 7 feet
Shrubs						
30	VD	Viburnum dentatum 'Christom'	Blue Muffin Vibumum	2 GAL	CONT.	15" height
30	IV	Itea virginica 'Henry's Garnet'	Henry's Garnet Sweetspire	2 GAL	CONT.	24" height
Perennials & Grasses						
38	CA	Calamagrostis acutiflora Karl Foerster	Karl Foerster Feather Reed Grass	1 GAL	CONT.	
500	CP	Cerastigma plumbaginoides	Plumbago	4"	POT	Evenly space qty into space indicated at approx. 15"o.c.
170	EP	Enchinacea purpurea "Hot Papaya"	Hot Papaya Coneflower	4"	POT	Evenly space qty into space indicated at approx. 15"o.c.
170	LS	Leucanthemum x superbum "Becky"	Becky Daisy	4"	POT	Evenly space qty into space indicated at approx. 15"o.c.

2 Plant Schedule

NO SCALE

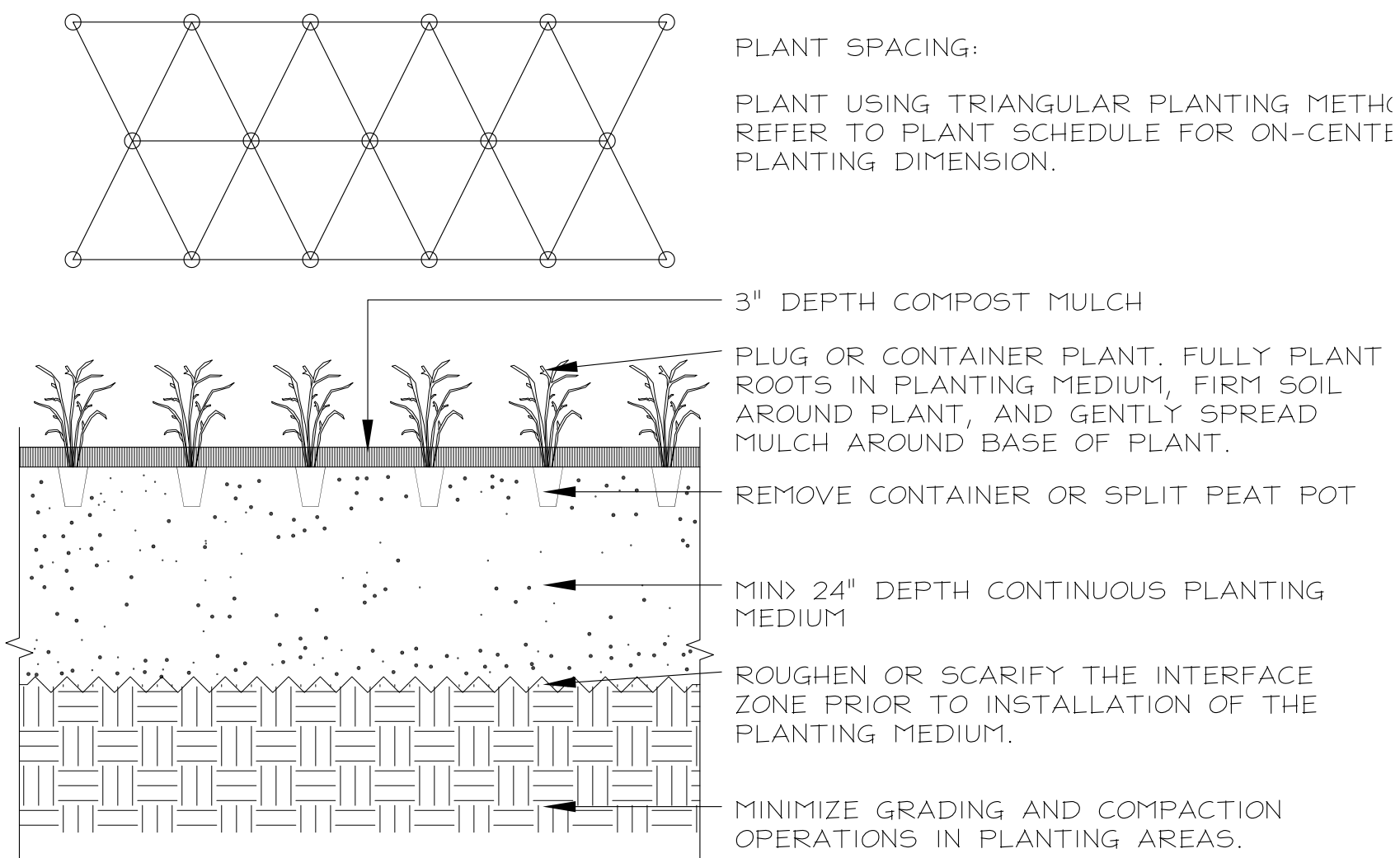

4 Perennial , Groundcover or Grass Planting

SCALE 1" = 1'-0"

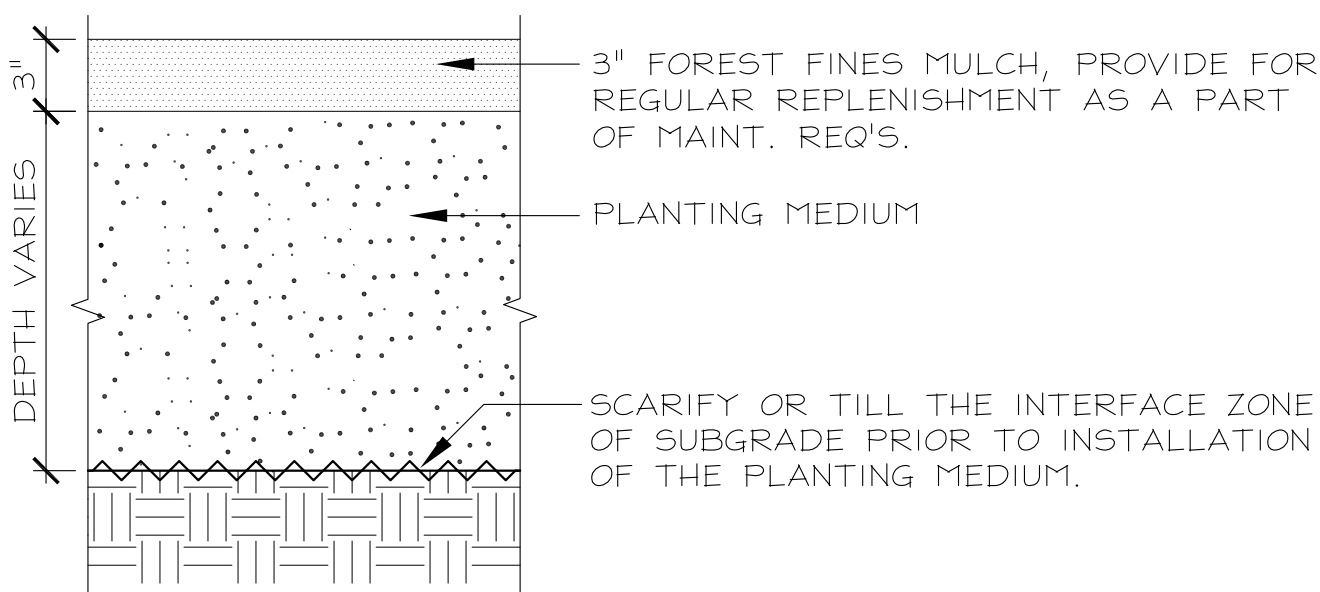

5 Soil Preparation

SCALE 1" = 1'-0"

Supplemental Planting Notes

- PLANTING
- ALL PLANT MATERIAL TO MEET THE LATEST EDITION OF ANSI Z60 STANDARDS (ANSI).
 - SUBMIT REPRESENTATIVE PHOTOS OF PLANT MATERIAL FOR APPROVAL BEFORE PLANTING. SHOULD PLANT MATERIALS BE SUBSTANTIALLY DIFFERENT FROM APPROVED PHOTOS, THE PLANT MATERIAL MAY BE REJECTED.
 - REMOVE ALL PLASTIC AND WIRE TAGS AND CORDS.
 - PRUNE BROKEN OR DEAD BRANCHES BEFORE PLANTING.
 - B&B MATERIAL: REMOVE BURLAP AT LEAST 12" BELOW FINISH GRADE AFTER POSITIONING ROOT BALL ON COMPACTED SOIL CONE. CUT TOP HALF OF WIRE BASKET OFF ROOT BALL BEFORE PLANTING. EXPOSE ROOT FLARE AND PLANT SO THAT ROOT FLARE MEETS FINISH GRADE OR UP TO 1/2" HIGHER.
 - CONTAINER MATERIAL: SCARIFY SIDES OF ROOT MASS BEFORE PLANTING. ALL ROOTS TO BE COVERED WITH SOIL BEFORE MULCHING. ROOT FLARE ELEVATION AT FINISH GRADE SHALL BE THE SAME AS IN THE CONTAINER.
 - PROVIDE TWO YEAR REPLACEMENT GUARANTEE AND TWO YEARS OF MAINTENANCE FROM DATE OF SUBSTANTIAL COMPLETION FOR ALL PLANT MATERIAL IN THE COST OF EACH PLANT. REPLACEMENTS SHALL BE WARRANTED AN ADDITIONAL 12 MONTHS. PROVIDE MAINTENANCE LOG TO OWNER AND DEVELOP APPROVED REPORTING PROTOCOL. MAINTENANCE TO INCLUDE:
 - THE CONTRACTOR SHALL ADJUST MAINTENANCE ACTIVITIES IN RESPONSE TO AMOUNT OF RAINFALL, WEED PRESSURES, PEST PRESSURES, ENVIRONMENTAL CONDITIONS OR OTHER FACTORS TO MAINTAIN PLANT VIGOR.
 - CULTIVATION AND WEEDING OF PLANTING AREAS TO KEEP THEM WEED-FREE.
 - TREES SHALL RECEIVE 10 GALLONS OF WATER PER 1" OF TREE CALIPER PER WEEK.
 - OTHER PLANT MATERIAL SHALL RECEIVE 5 GALLONS OF WATER PER PLANT PER WEEK.
 - WATERING PROCEDURES TO BE APPROVED.
 - REPLENISH MULCH TO 3 INCH DEPTH AT BEGINNING AND END OF EACH GROWING SEASON.
 - OWNER SHALL ASSUME PLANT MAINTENANCE UPON FINAL ACCEPTANCE AT CONCLUSION OF MAINTENANCE PERIOD. ACCEPTANCE IS PREDICATED ON MEETING MAINTENANCE REQUIREMENTS AND THAT ALL PLANT MATERIALS ARE ALIVE AND IN A HEALTHY, VIGOROUS CONDITION.
- SOIL PREPARATION
- SUBGRADE TO SLOPE TOWARD DRAIN LINES. PREPARE SUBGRADE SURFACE BY ROUGHENING TOP LAYER TO A DEPTH OF 6". ACCEPTABLE METHODS INCLUDE BACK-DRAWING TOOTHED BACKHOE BUCKET OR MECHANICAL TILLER.
 - PLANT MEDIUM INSTALLATION: MINIMUM DEPTH 24 INCHES. INSTALL AS SOON AS SUBGRADE SURFACE IS PREPARED. INSTALL PLANT MEDIUM IN 12" LIFTS AND ROUGHEN SURFACE TO MIN. 6" DEPTH AFTER LOADER PLACES SOIL, AND BEFORE PLACING NEXT LIFT. ALTERNATIVELY, INSTALL SOIL IN BANDS AT FULL DEPTH.
 - INSTALL MIN. 2" DEPTH ADDITIONAL PLANTING MEDIUM PER FOOT TO ALLOW FOR SETTLEMENT TO FINISH GRADE.
 - COMPACTION: COMPACT PLANTING MEDIUM SUFFICIENTLY TO REDUCE SETTLEMENT, BUT NOT TO THE POINT WHERE THE SOIL RESISTS ROOT PENETRATION (APPROX. 80% PROCTOR). AVOID REPEATED PASSES BY VEHICLES TO MINIMIZE COMPACTION. ROUGHEN EACH SOIL LIFT TO SIX" DEPTH BEFORE PLACING NEXT LIFT.
 - PLANTING MEDIUM: APPROVED TOPSOIL MODIFIED WITH APPROVED SOIL AMENDMENTS TO ACHIEVE:
 - TOTAL NITROGEN OF 0.2% TO 0.6% BY WEIGHT.
 - AVAILABLE PHOSPHORUS OF 20 - 250 PPM.
 - AVAILABLE POTASSIUM OF 50 - 1000 PPM.
 - PH OF 6.0 - 7.0
 - NO MORE THAN 35% CLAY, 45% SILT, OR 25% FINE SAND.
 - FREE OF STONES, WOOD, OR OTHER EXTRANEIOUS MATERIALS OVER 1/2" OR LARGER IN ANY DIMENSION.
 - CLOD SIZES ALLOWED: LESS THAN 1 INCH: UP TO 90%; 1 TO 3 INCHES: 15-20%; 3-6 INCHES: 5-10%; GREATER THAN 6": LESS THAN 2%.
 - MIX 1 PART PRE-APPROVED HIGH-LIGNIN COMPOST TO 10 PARTS TOPSOIL.
 - 25 COMMON, LIVE EARTHWORMS PER ONE CY PLANTING MEDIUM, ALLOWED TO BURROW INTO THE SOIL AFTER PLANTING AND BEFORE MULCH IS APPLIED.
- COMPOST MULCH
- PRE-APPROVED BIOLOGICALLY ACTIVE MATERIAL RESULTING FROM THE DECOMPOSITION OF ORGANIC MATERIAL (LEAVES OR BARK FINES), PH RANGE 5.5 - 8, PASSING A 1" SIEVE, AND FREE OF SUBSTANCES TOXIC TO PLANTS.





Shade Tree
Red Oak



Flowering Tree
Eastern Redbud (spring flowering)



Hedge Tree
Hornbeam



Flowering Shrub
Viburnum



Low flowering shrub screen
Henry's Garnet Sweetspire



Perennial border:
Daisy

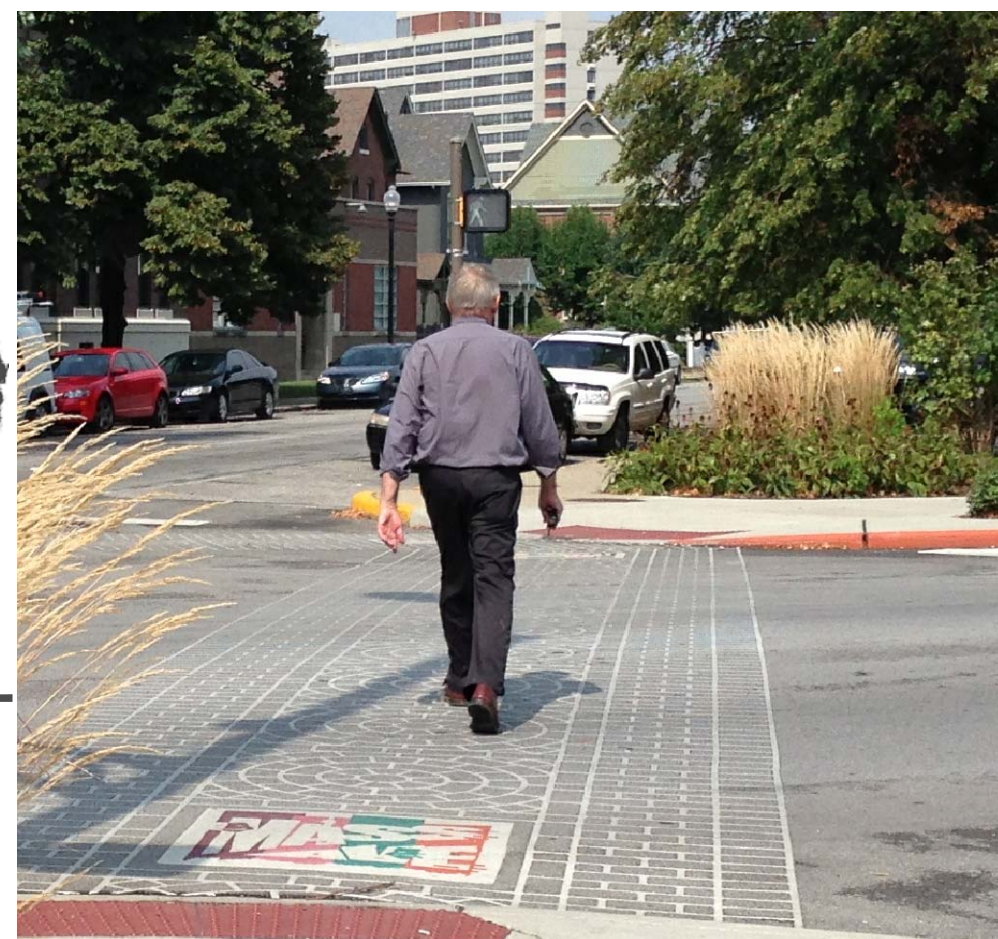

Feather
Reed Grass



Limestone
Block Wall



Perennial border:
Coneflower



Groundcover
Plumbago