

Sears

repair parts manual

UNIMAT

multi-purpose precision lathe

MODEL NO.
736.21410

CAUTION
Read Instructions
Carefully

- Assembly
- Operating
- Repair Parts

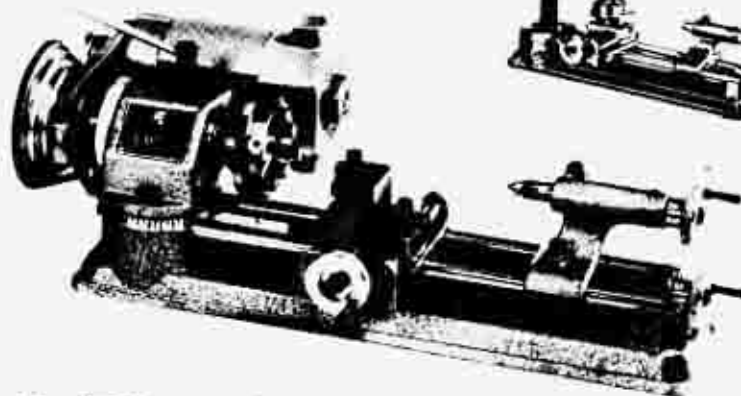
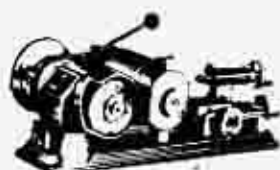

SEARS, ROEBUCK AND CO. U.S.A.
SIMPSON-SEARS LIMITED, CANADA

E. HEADSTOCK SPINDLE ASSEMBLY



UNIMAT—Multi-purpose Metal Lathe

Model No. 736.21410

REPAIR PARTS LIST

Numbers shown here are key or reference numbers only. When ordering replacements, be sure to specify Part No. and description.

F. MOTOR SUPPORT / IDLER ASS'Y

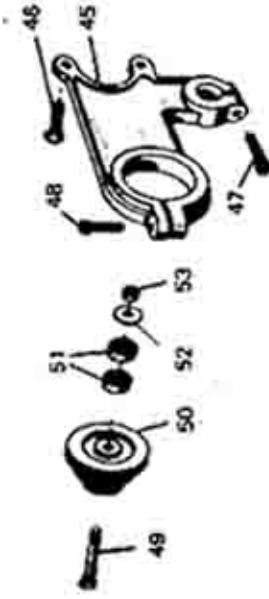

D. HEADSTOCK

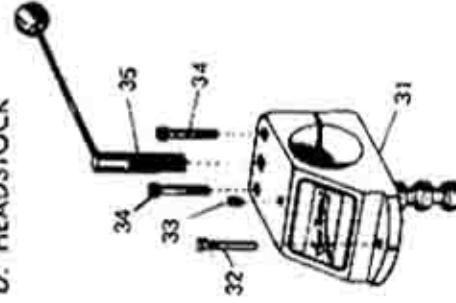

G. MOTOR ASSEMBLY

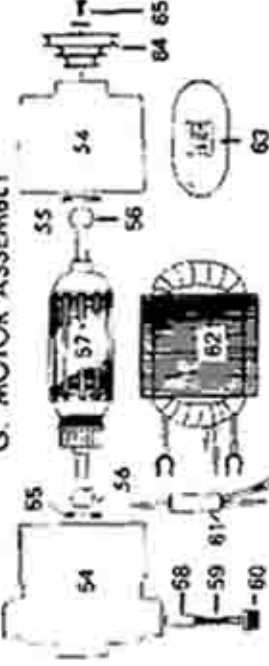

CARRIAGE / CROSS-SLIDE / TOOL POST

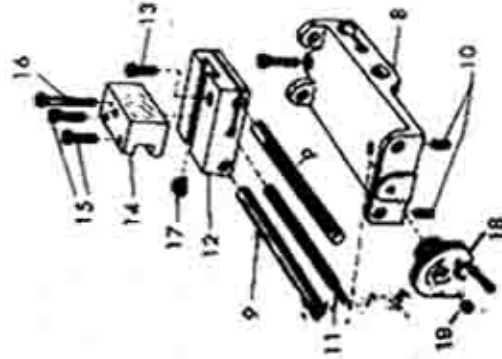

A. LATHE BED ASS'Y

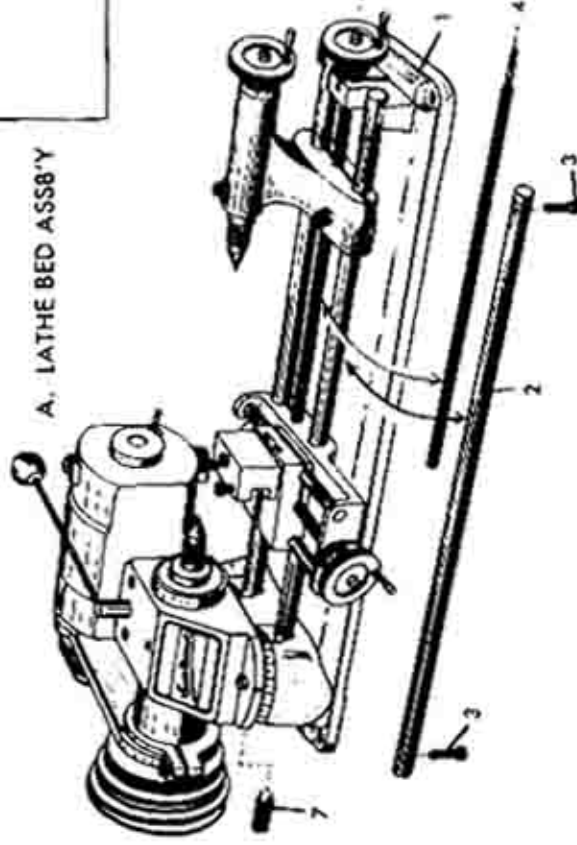

C. TAILSTOCK ASSEMBLY

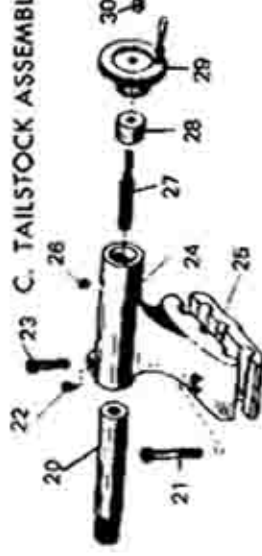

H. MISCELLANEOUS PARTS

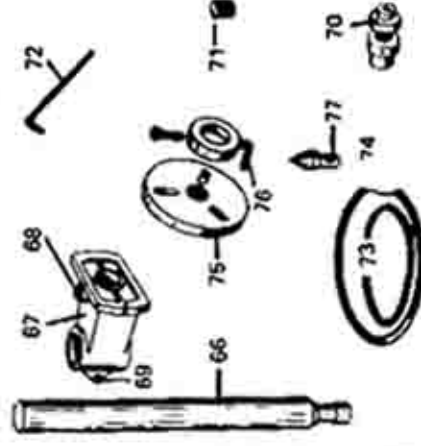

UNIMAT

repair parts manual

Key No.	Part No.	Description	Key No.	Part No.	Description	Key No.	Part No.	Description
A. BED ASSEMBLY								
1	501-1	Bed	26	606	Screw, Din 553 M 6 x 6	49	102-22	Idler shaft
2	201-2	Bed way (2-req'd)	27	103-3	Feed screw	50	102-7	Idler pulley
3	620	Screw, M6 x 20 (2-req'd)	28	203-4	Bushing	51	35-4	Ball bearing E16
4	201-5	Leadscrew	29	501-60	Handwheel & crank assembly	52	102-23	Bearing plate
5	501-60	Handwheel & crank assembly	30	13	Nut, M 5	53	35-3	Nut, M 6
6	13	Nut, M 5	D. HEADSTOCK			G. MOTOR ASSEMBLY		
7	501-8	Clamping screw	31	501-2	Headstock casting	U-90		115V, 60 C Motor Assy. Comp. (items 54-65)
B. CARRIAGE / CROSS SLIDE / TOOL POST			32	501-9	Alignment pin & nut assembly	54	90-1	Motor housing (2 part Assembly)
8	502-1	Carriage	33	608	Screw, Din 417 M 6x8	55	90-5	Washer (2-req'd)
9	104-2	Cross slide way (2-req'd)	34	630	Screw, M 6 x 30 (2 req'd)	56	90-4	Bearing (2-req'd)
10	410	Screw, M 4 x 10 (2-req'd)	35	202-1400	Pinion & handlever assembly	57	90-2	Armature
11	104-8	Cross slide feed screw	E. HEADSTOCK SPINDLE ASSEMBLY			58	90-7	Carbon brush
12	204-3	Cross slide	202-300		Headstock spindle Assembly, complete (item 36-44)	59	90-8	Spring
13	612	Screw, M 6 x 12	36	302-5	Spindle shaft	60	90-9	Brush cap
14	104-5	Tool post	37	202-4	Bearing plate	61	90-6	Capacitor
15	615	Screw, M 6 x 15 (2-req'd)	38	25-2	Ball bearing E-13	62	90-3	Field
16	630	Screw, M 6 x 30	39	202-6	Spacer	63	91	Switch assembly
17	104-7	T-nut	40	202-3	Spindle housing	64	102-7M	Pulley
18	501-60	Handwheel & crank assembly	41	25-5	Cup spring 6200 K	65	40-2	Screw & Washer Assembly
19	13	Nut M 5	42	25-2	Ball bearing E-13	H. MISCELLANEOUS PARTS		
C. TAILSTOCK ASSEMBLY			43	402-7	Spindle pulley	66	503-3	Vertical Column
501-30		Tailstock Assembly, Complete (items 20-30)	44	102-8	Pulley nut	67	503-1	Headstock adaptor
103-2		Tailstock spindle	F. MOTOR SUPPORT / IDLER ASSEMBLY			68	501-8	Clamping screw
21	630	Screw M 6 x 30	45	202-21	Motor support casting	69	620	Screw, M 6 x 20
22	608	Screw, Din 417 M 6 x 8	46	515	Screw, M 5 x 15 (2 req'd)	70	106	Grinding wheel arbor Ass'y.
23	620	Screw, M 6 x 20	47	620	Screw, M 6 x 20	71	103-5	Slotted adaptor screw
24	501-3	Tailstock casting	48	625	Screw, M 6 x 25	72	66	Allen wrench 6mm
25	501-4	Clamp plate	102-20		Idler Assembly, Complete (items 49-53)	73	50-1	Rubber drive belt, small 50mm
						74	50-2	Rubber drive belt, large 70mm
						75	206-2	Face plate
						76	106-80	Lathe dog
						77	106-3	Center

Sears

repair parts manual

UNIMAT

multi-purpose precision lathe

MODEL NO.
736.21410

HOW TO ORDER REPAIR PARTS

**SEARS SERVICE
IS AT YOUR SERVICE
WHEREVER YOU LIVE
OR MOVE IN
THE U.S.A.**

The Model Number will be found on a plate attached to the outside of the headstock casting. Always mention the Model Number when requesting service or repair parts for your UNIMAT.

All parts listed herein may be ordered through SEARS, ROEBUCK AND CO. or SIMPSON'S-SEARS LIMITED. When ordering parts by mail, selling prices will be furnished on request or parts will be shipped at prevailing prices and you will be billed accordingly.

WHEN ORDERING REPAIR PARTS, ALWAYS GIVE THE FOLLOWING INFORMATION AS SHOWN IN THIS LIST.

- | | |
|-------------------------|----------------------|
| 1. The PART NUMBER | 3. The MODEL NUMBER |
| 2. The PART DESCRIPTION | 736.21410 |
| | 4. The NAME OF ITEM— |
| | UNIMAT. |

Your Sears Merchandise takes on added value when you discover that Sears has over 2,000 Service Units throughout the country. Each is staffed by Sears-trained, professional technicians using Sears approved parts and methods.

SEARS, ROEBUCK AND CO. U.S.A.
SIMPSON'S-SEARS LIMITED, CANADA