

Accessories for UNIMAT SL

CAMPBELL TOOLS CO.
2100 Seima Rd. Springfield, Ohio 45505
(513) 322-8562

10/83

UNIMAT

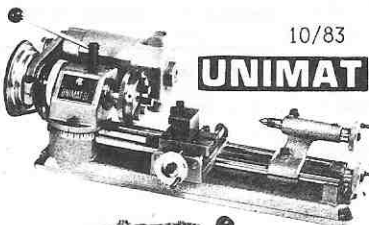

Accessories are available for both the discontinued Model SL and the older Model DB-200. Order today from this list.

List Price WT. Order Number OLD NUMBER

\$ 2.50	1 oz.	130.090 (51)	Replacement belt 1.75" x 0.18"
\$ 2.50	1 oz.	130.091 (52)	Replacement belt 2.75" x 0.20"
\$ 65.00	1 lb.	100.100 (1001)	Three-jaw chuck
\$ 21.00	2 oz.	100.300 (DB106135)	Set of three exchange jaws for 100.100 (Soft)
\$ 77.50	1 lb.	100.200 (1002)	Four-jaw chuck
\$ 22.00	6 oz.	100.500 (1005)	Three-jaw drill chuck
\$ 47.50	3 oz.	101.000 (1010)	Machine vice
\$ 53.50	8 oz.	102.000	Collet holder for collets 152.210-152.280 ES-16
\$282.00	16 oz.	152.200	10-piece collet set 1-8 mm (1/32" x 9/32") ES-16 In Box
\$ 26.50	each	152.210 to 152.280	Single collets Type ES-16

E-16 collets for Unimat SL, Unimat 3, and FB-1 Mill have been replaced by the ES-16, a dual range inch-metric collet which has double the range of the E-16. This is accomplished by doubling the number of slits in each collet.

\$144.00	2 lb.	102.200 (2800)	Watchmaker spindle (uses B-8 collets) (WW)
\$135.00	8 oz.	102.300 (2815)	8-piece collet set, type B 8, inch-type (1/32" to 1/4") (WW)
\$150.00	8 oz.	102.310 (2815)	8-piece collet set, type B 8, metric (1-8 mm) (WW)
\$ 20.00	each	102.301 to 102.308 (2815)	Single collets, type B 8
		102.301	1/32"
		102.302	1/16"
		102.303	3/32"
		102.304	1/8"
		102.305	5/32"
		102.306	3/16"
		102.307	7/32"
		102.308	1/4"

[Additional "WW" collet sizes on Page 13].

\$ 24.00	8 oz.	103.000 (1030)	Polishing arbor
\$ 35.00	1 lb.	104.000 (1040)	Fixed steady rest
\$106.50	10 lb.	108.000 (1080)	Fret- and Jig-saw attachment with one dozen blades
\$ 32.50	1 lb.	120.200 (1202)	Adjustable tool rest
\$ 8.00	2 oz.	120.500 (1205)	Drive center
\$ 42.50	2 lb.	121.000 (1210)	Milling table with clamps
\$ 10.00	1 oz.	121.200 (1210/2)	Stud clamps
\$ 15.50	6 oz.	124.500	Arbor for gear milling cutters
\$ 10.00	6 oz.	131.100 (1311)	Intermediate piece (reqd for 105.000, 124.000, 133.000)
\$ 49.00	1 lb.	106.200 (1060)	Jointer attachment
\$ 22.00	3 oz.	122.200 (1221)	Live center
\$ 59.00	3 lb.	124.000 (1240)	Circular saw attachment without blade
\$ 13.50	10 oz.	124.100 (1244)	Mitre gauge for circular saw
\$ 39.50	1 lb.	126.100 (1261)	Circular clamping table

\$ 52.00	1 lb.	126.000 (1260)	Indexing-dividing attachment with division plate 48
\$ 15.50	3 oz.	126.500 (1263/30)	Division plate 30
\$ 15.50	3 oz.	126.600 (1263/36)	Division plate 36
\$ 15.50	3 oz.	126.700 (1263/40)	Division plate 40
\$ 80.50	3 lb.	127.000 (1270)	Threading attachment without formers and guides
\$125.00	36 oz.	127.100 (1271)	9-piece former and guide set, metric (0.5 - 1.5 mm)
\$165.00	56 oz.	127.150 (1271)	14-piece former and guide set, inch-type (18 - 56 tpi)
\$ 15.00	4 oz.	127.151 to 127.164 (1271)	Single formers and guides, inch-type
		127.151	16 tpi
		127.152	18 tpi
		127.153	20 tpi
		127.154	22 tpi
		127.155	24 tpi
		127.156	26 tpi
		127.157	28 tpi
		127.158	30 tpi
		127.159	32 tpi
		127.160	36 tpi
		127.161	40 tpi
		127.162	48 tpi

\$ 37.00	2 lb.	128.000 (1280)	Motor bracket with reduction pulley
\$116.50	6 lb.	129.000 (1290)	Automatic longitudinal power feed
\$ 19.00	4 oz.	133.000 (1330)	Sanding Disc & Dr. Press Support
\$ 12.00	6 oz.	116.500 (1261/3)	Rubber disc with arbor
\$ 48.50	3 lb.	139.500 (1390)	Wood turning attachment
\$ 17.00	12 oz.	134.000 (1115)	Tool grinder guard
\$ 5.00	7 oz.	992.020	Operating and spare parts manual

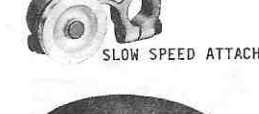
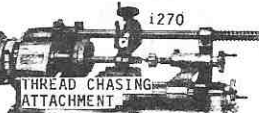
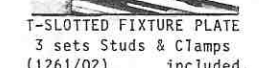
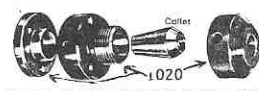
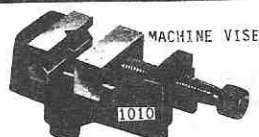
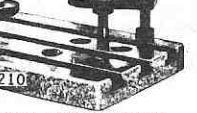
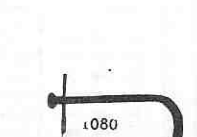
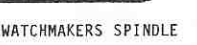
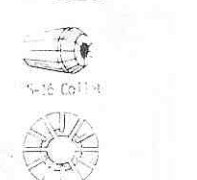
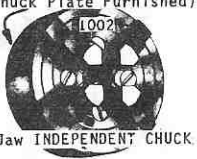
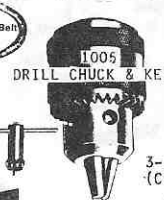
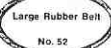

REPLACEMENT PARTS LIST for UNIMAT SL

CAMPBELL TOOLS COMPANY
2100 Selma Rd. Springfield, Ohio 45505
Phone 513 - 322-8562

10/83

All replacement parts listed on this sheet are available within a few days. Most parts will also fit the older DB-200 Unimat. Please add shipping costs when ordering.

When castings are not available, we suggest ordering the complete accessory. (See Page 11)

Parts for some accessories are not listed here. Please Inquire.

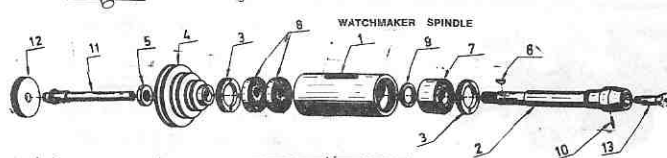
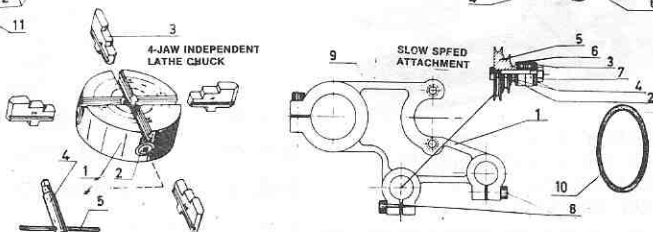
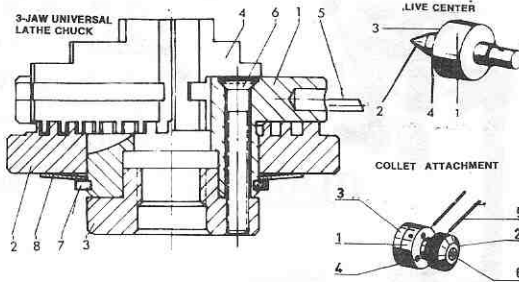
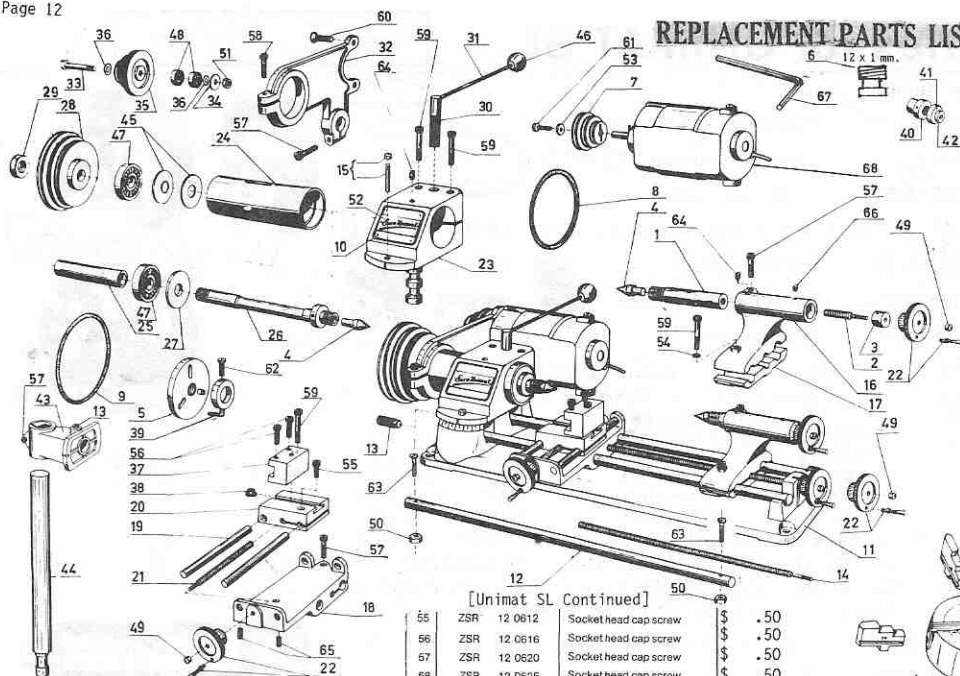

Pos	EMCO Unimat SL	DESCRIPTION	PRICE
1	A2A 000 010	Tailstock ram	\$ 34.00
2	A2A 000 020	Lead screw	\$ 5.40
3	A2A 000 030	Guide pin	\$ 6.20
4	A2A 000 040	Center	\$ 2.90
5	A2A 000 050	Face plate	\$ 20.50
6	A2A 000 060	Slotted Adpt. Screw	\$ 1.90
7	A2A 000 070	Pulley	\$ 11.50
8	A2A 000 080	Rubber belt 1.75"x.187"	\$ 2.50
9	A2A 000 090	Rubber belt 2.75"x.187"	\$ 2.50
10	A2A 000 100	Name plate	\$ 1.60
11	A2A 010 010	Name plate USA	\$ 1.60
12	A2A 010 020	Bed	\$ 78.00
13	A2A 010 030	Guide column	\$ 7.50
14	A2A 010 040	Tension screw	\$ 4.60
15	A2A 010 050	Threaded spindle	\$ 10.70
16	A2A 010 060	Marker pin	\$ 2.70
17	ZME 404 000	Tailstock Complete	\$ 56.00
18	A2A 040 000	Tailstock housing & clamp	\$ 30.00
19	A2A 010 070	Clamping plate	\$ 12.90
20	A2A 020 000	Support Complete	\$ 114.00
21	A2A 020 010	Support casting	\$ 41.50
22	A2A 020 020	Guide column each	\$ 2.10
23	A2A 020 030	Carriage casting	\$ 32.00
24	A2A 020 040	Threaded spindle	\$ 4.80
25	A2A 020 050	Hand wheel	\$ 8.00
26	A2A 040 000	Spindle Assembly	\$ 113.00
27	A2A 300 000	Headstock	\$ 40.50
28	A2A 040 010	Spindle head sleeve	\$ 24.50
29	A2A 040 020	Distance bush	\$ 6.20
30	A2A 040 030	Main spindle SL	\$ 31.50
31	A2A 040 040	Spindle wheel	\$ 2.70
32	A2A 040 050	Belt pulley for spindle	\$ 21.50
33	A2A 040 060	Nut	\$ 3.80
34	A2A 050 000	Pinion (handle)	\$ 18.20
35	A2A 050 010	Pinion only	\$ 14.20
36	A2A 050 020	Long locking handle	\$ 2.70
37	A2A 060 000	Motor Bracket	\$ 55.00
38	A2A 060 010	Motor bracket only	\$ 24.80
39	A2A 060 020	Bearing bolts	\$ 4.80
40	A2A 060 030	Cover disc	\$ 1.90
41	A2A 060 040	Idle Pulley	\$ 8.30
42	A2A 060 050	Washer 14x6.4x0.5	\$.30
43	A2A 070 010	Tool holder	\$ 10.70
44	A2A 070 020	Toolholder Complete	\$ 15.60
45	A2A 070 030	T-nut	\$ 1.60
46	A2A 080 010	Lathe dog	\$ 6.20
47	A2A 080 020	Lathe Dog Complete	\$ 6.20
48	A2A 090 010	Grinding wheel adaptor	\$ 7.50
49	A2A 090 020	Grind. Whl. Adapt. Complete	\$ 19.80
50	A2A 090 030	Retaining ring	\$ 4.80
51	A2A 090 040	Screw	\$ 4.30
52	A2A 100 010	Headstock adaptor coating	\$ 43.00
53	A2A 100 020	Vertical column	\$ 19.80
54	A2A 400 000	Tailstock Complete	\$ 30.00
55	A2A 300 000	Headstock Complete	\$ 40.50
56	ZFD 94 2971	Disc spring	\$.50
57	ZGF 19 2005	Plastic ball	\$.80
58	ZLG 00 1300	Ball bearing	\$ 7.80
59	ZLG 06 2600	Ball bearing	\$ 4.60
60	ZMU 17 0500	Domed nut	\$.50
61	ZMU 34 0500	Nut	\$.30
62	ZMU 34 0600	Nut	\$.30
63	ZNA 76 0144	Rivet	\$.30
64	ZSB 25 0430	Washer	\$.50
65	ZSB 25 0640	Washer	\$.30

[Unimat SL Continued]

56	ZSR 12 0612	Socket head cap screw	\$.50
57	ZSR 12 0616	Socket head cap screw	\$.50
58	ZSR 12 0620	Socket head cap screw	\$.50
59	ZSR 12 0625	Socket head cap screw	\$.50
60	ZSR 12 0630	Socket head cap screw	\$.50
61	ZSR 63 0515	Countersunk screw	\$.30
62	ZSR 84 0408	Cheese head screw	\$.30
63	ZSR 84 0525	Cheese head screw	\$.30
64	ZSR 91 0525	Flat head screw	\$.30
65	ZST 17 0608	Dog point grub screw	\$.50
66	ZST 53 0410	Cone point grub screw	\$.30
67	ZST 53 0606	Cone point grub screw	\$.50
68	ZWZ 11 0500	Allen key	\$ 1.30
69	ZME 847 116	Motor Type U67750	\$130.00
		GEFEG	

Pos	3-Jaw Chuck	DESCRIPTION	PRICE
1	A2Z 410 010	Body	\$ 40.50
2	A2Z 410 020	Scroll	\$ 26.50
3	A2Z 410 030	Flange	\$ 14.70
4	ZME 400 003	Jaws 1 set of 3	\$ 24.50
5	A2Z 410 050	Dowel pin	\$ 2.70
6	ZSR 63 0425	Countersunk screw	\$.30
7	ZRG 71 3015	Snap ring	\$.50
8	ZFD 94 4653	Disc spring	\$.80

Pos	Collet Attachment	DESCRIPTION	PRICE
1	A2Z 290 010	Holder	\$ 72.00
2	A2Z 290 020	Locking ring	\$ 35.50
3	A2Z 290 030	Flange	\$ 13.40
4	ZSR 63 0420	Countersunk screw	\$.30
5	A2Z 410 050	Dowel pin	\$ 2.70
6		Collet	(See Accessory List)

Pos	Watchmaker Spindle	DESCRIPTION	PRICE
1	A2Z 280 010	Spindle sleeve	(NOT AVAILABLE)
2	A2Z 280 020	Spindle	\$ 63.00
3	A2Z 280 030	Screw	\$ 13.70
4	A2Z 280 040	Belt pulley	\$ 29.00
5	A2A 040 060	Nut	\$ 3.80
6	ZFD 88 0226	Circlip	\$.50
7	ZLG 80 4903	Needle bearing	\$ 22.50
8	ZLG 00 1307	Ball bearing	\$ 13.40
9	ZRG 21 0170	Spring ring	\$.50
10	ZST 06 0156	Dowel pin	\$.30
11	A2Z 280 050	Draw bar	\$ 32.50
12	A2Z 280 060	Tension wheel	\$ 5.40
13		Collet	(See Accessory List)

Pos	Independent chuck	DESCRIPTION	PRICE
1	A2Z 420 010	Body	\$ 46.50
2	A2Z 420 020	Adjusting screw	\$ 5.10
3	ZME 400 004	Jaws 1 set of 4	\$ 33.00
4	A2Z 420 040	Key	\$ 8.80
5	ZST 75 0460	Key handle	\$.50

Pos	Slow speed motor bracket	DESCRIPTION	PRICE
1	A2Z 340 010	Motor bracket	\$ 24.80
2	A2A 050 020	Bearing bolt	\$ 4.80
3	A2A 060 030	Cover plate	\$ 1.90
4	A2A 060 050	Washer	\$.30
5	A2A 060 040	Belt pulley Intermed. Gear	\$ 8.30
6	ZLG 06 2600	Ball-bearing	\$ 4.60
7	ZMU 34 0600	Nut	\$.30
8	ZSR 12 0620	Socket head cap screw	\$.50
9	ZSR 12 0625	Socket head cap screw	\$.50
10	A2A 000 080	Rubber ring	\$ 1.90

Pos	Milling table assy.	DESCRIPTION	PRICE
1	A2Z 350 010	Milling table	(NOT AVAILABLE)
2	A2Z 351 010	Clamping claws	\$ 3.50
3	ZSR 12 0620	Socket head cap screw	\$.50
4	A2Z 352 010	Clamping screw	\$ 5.40
5	ZSB 25 0640	Shim	\$.30
6	ZMU 34 0600	Hexagon nut	\$.30
7	A2A 070 020	Hexagon nut	\$ 1.60
8	ZSR 12 0612	Socket head cap screw	\$.50

Pos	Live center, double	DESCRIPTION	PRICE
1	A2Z 270 010	Body	(NOT AVAILABLE)
2	A2Z 270 020	Point	\$ 5.90
3	A2Z 270 030	Cover	(NOT AVAILABLE)
4	ZLG 06 2600	Ball bearing	\$ 4.60

Pos	Steady assy.	DESCRIPTION	PRICE
1	A2Z 240 010	Steady	(NOT AVAILABLE)
2	A2Z 240 020	Slide pin	\$ 1.60
3	ZSR 12 0612	Socket head cap screw	\$.50
4	ZSR 12 0620	Socket head cap screw	\$.50

Pos	VISE	DESCRIPTION	PRICE
1	A2Z 310 010	Body	\$ 48.00
2	A2Z 310 020	Moving jaw	\$ 25.00
3	A2Z 310 030	Small plate	\$ 5.40
4	A2Z 310 041	Fixed jaw	\$ 14.50
5	A2Z 310 050	Operating screw	\$ 1.10
6	ZST 06 0220	Dowel pin	\$.50
7	A2A 070 020	T-nut	\$ 1.60
8	ZSR 12 0610	Socket head cap screw	\$.50
9	ZSR 63 0508	Countersunk screw	\$.30
10	ZSR 84 0410	Cheese head screw	\$.30

Pos	Dividing Head	DESCRIPTION	PRICE
1	A2Z 320 010	Body	\$ 48.00
2	A2Z 320 020	Index plate 48	\$ 29.50
		Index plate 30	\$ 29.50
		Index plate 36	\$ 29.50
		Index plate 40	\$ 29.50
3	A2Z 320 030	Index plunger	\$ 12.30
4	A2Z 320 040	Hollow screw	\$ 7.80
5	A2Z 320 050	Index spring	\$ 1.10
6	A2Z 070 020	T-nut	\$ 1.60
7	ZMU 66 0400	High knurled nut	\$.80
8	ZSR 12 0616	Socket head cap screw	\$.50
9	ZSR 12 0612	Socket head cap screw	\$.50
10	ZRG 72 3515	Snap ring	\$.50
11	A2Z 320 060	Socket head key	1.60

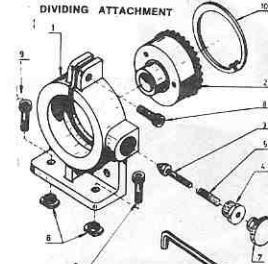
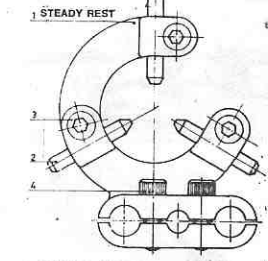
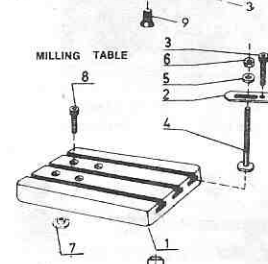
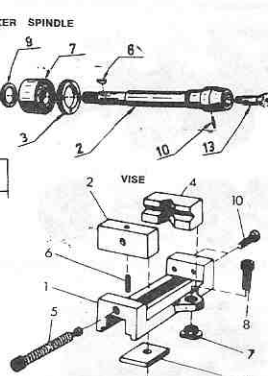
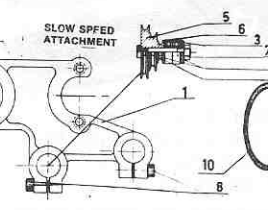

BRUSH NO.:	MOTOR TYPE:	LATHE:	PRICE:
#ZME.900.001...U90	Model DB-200 (older)	\$ 6.40ea.
#ZME.100.001...U100	SL with plastic shell	6.40ea.
#ZME.848.001...UG7750	SL (also called 1000)	4.90ea.
#ZME.850.001...UG7750-25..	Unimat 3 (current)	10.50ea.

LATHE ACCESSORIES & ATTACHMENTS

FOR SMALL PRECISION LATHES UP TO 5 INCH SWING

Campbell Tools Co.
PRECISION TOOLS - SHOP SUPPLIES
2100 Selma Road
Springfield, Ohio 45505
(513) 322-8562

NUMBER	PRICE	SH. WT.	DESCRIPTION
2700-R (130.141)	\$10.00	4 oz.	1/4" R/H TOOL HOLDER & FORMED BIT
2700-L (130.142)	\$10.00	4 oz.	1/4" L/H TOOL HOLDER & FORMED BIT
2701-R	\$10.00	4 oz.	5/16" R.H. TOOL HOLDER & BIT
2701-L	\$10.50	4 oz.	5/16" L.H. TOOL HOLDER & BIT
2710 (130.143)	\$14.00	3 oz.	BORING BAR 1/4" & BIT (DBLE ENL)
2712	13.70	3 oz.	BORING BAR 3/8" & BIT (DBLE ENL)
2713	14.35	4 oz.	BORING BAR 1/2" & BIT (DBLE ENL)
2719	3.00	1 oz.	SET OF 2 V-BLOCKS
2722 (130.151)	\$10.00	1 oz.	SET OF 5 BITS T-15 H.S. COBALT
2725 (130.152)	10.00	1 oz.	SET OF 2 BITS FORMED CARBIDE
2750	\$10.00	2 oz.	FLY CUTTER 1/2" SHANK INCLUDES CARBIDE INSERT & ALLEN KEY
2760 (130.144)	10.00	3 oz.	5/16" SHANK CUTOFF HOLDER WITH 1/16" thick x 7/32" x 2.375" BLADE
2761 (130.153)	10.00	1 oz.	SET OF 3 REPLACEMENT BLADES FOR ABOVE HOLDER
2790-S	\$39.50	2 oz.	13 PIECE TOOL SET 1/4" CAPACITY
2791-S(5-300)	39.95	7 oz.	13 PIECE TOOL SET 5/16" CAPACITY
2870-12	11.00	2 oz.	12 x 1mm TAP FOR UNIMAT SL
2871-12	15.98	2 oz.	12 x 1mm H.S. DIE FOR SL SPINDLE
2872-12	4.95	2 oz.	TAP DRILL FOR 12 x 1 TAP
2870-14	13.00	2 oz.	14 x 1mm TAP FOR UNIMAT 3.
2871-14	29.46	3 oz.	14 x 1mm H.S. DIE FOR U. 3.
2872-14	9.66	3 oz.	TAP DRILL FOR U3 SPINDLE THREAD
A2Z-410-300	\$14.70	1 oz.	3 HOLE PLATE FOR UNIMAT SL CHUCK.
ZSR.630.425	.90	1/2 oz.	SET OF 3 SCREWS FOR ABOVE. 4x25.
A2Z.290.030	13.40	1 oz.	3 HOLE PLATE FOR COLLET HOLDER.
ZSR.630.420	.90	1/2 oz.	SET OF 3 SCREWS 4x25 FOR ABOVE.

WW Adaptor fits Unimat spindle - is threaded 12x1mm. to hold either Unimat 3 or 4 jaw chucks, also 100.500 drill chuck.

Adaptor.No. SOA 000 050...\$39.00
Nut....No. A2A 040 060...\$ 3.80
Washer..No. A2A 090 020...\$ 4.80
Straight Grinding Wheel
(2.5"x0.24"x0.6") #112-400...\$5.00



CONVERTIBLE SNAP RING PLIERS One plier works for both internal and external snap rings, especially Unimat lathe accessories.
No. 12R SHWT. 4 OZ. \$6.90 EA.

ELECTRONIC SPEED CONTROL



Specially designed for Unimat, electronic device provides infinitely variable speed control of any small universal type motor. Control knob varies speed or switches instantly to full rpm operation. Includes 3-wire cable and connector.

Rating	Stock No.	Each	Shpg. Wt.
5 Amp.	4X599	\$ 28.20	1 1/4
10 Amp.	4X701	\$ 37.10	1 1/4

EMCO-LUX ADJUSTABLE TOOLPOST



Fits on Unimat 3 cross-slide. Can be adjusted for any cutting height or turning tool. (Does not fit Unimat SL).
153.000 Adjustable Toolpost \$15.00

W. W. LATHE COLLETS (WIRE CHUCKS)

Body of collet is 8 mm. Number indicates the size in tenths of a millimeter. A collet stamped 25 equals 2.5 mm. Available in all sizes listed.

WW COLLETS (B8) #3 - #4 \$18.30 EACH
WW COLLETS (B8) #5 - #30 \$11.95 EACH

SET OF 8 METRIC SIZE COLLETS No. 2816 \$93.00 SET
(1.0, 2.0, 3.0, 4.0, 5.0, 6.0, 7.0, 8.0 mm)

SET OF 8 INCH SIZE COLLETS No. 2815 \$93.00 SET
(1/32, 1/16, 3/32, 1/8, 5/32, 3/16, 7/32, 1/4") Wt. 4 Oz.

Shipping Weight 1 oz. each

Collet Measurements

Collet No.	M/M	Sizes	Inches	Collet No.	M/M	Sizes	Inches
1	.1	.0039	N.A.	40	4.0		.1575
2	.1	.0079	N.A.	41	4.1		.1614
3	.1	.0118		42	4.2		.1654
4	.1	.0157		43	4.3		.1693
5	.1	.0197		44	4.4		.1732
6	.1	.0236		45	4.5		.1772
7	.1	.0276		46	4.6		.1811
8	.1	.0315		47	4.7		.1850
9	.1	.0354		48	4.8		.1890
10	.1	.0394		49	4.9		.1929
11	.1	.0433		50	5.0		.1969
12	.1	.0472		51	5.1		.2008
13	.1	.0512		52	5.2		.2047
14	.1	.0551		53	5.3		.2087
15	.1	.0591		54	5.4		.2126
16	.1	.0629		55	5.5		.2165
17	.1	.0669		56	5.6		.2205
18	.1	.0709		57	5.7		.2244
19	.1	.0748		58	5.8		.2283
20	.1	.0788		59	5.9		.2323
21	.1	.0826		60	6.0		.2362
22	.1	.0866		61	6.1		.2401
23	.1	.0905		62	6.2		.2441
24	.1	.0945		63	6.3		.2480
25	.1	.0984		64	6.4		.2520
26	.1	.1024		65	6.5		.2559
27	.1	.1063		66	6.6		.2598
28	.1	.1102		67	6.7		.2638
29	.1	.1142		68	6.8		.2677
30	.1	.1181		69	6.9		.2716
31	.1	.1221		70	7.0		.2756
32	.1	.1260		71	7.1		.2795
33	.1	.1299		72	7.2		.2835
34	.1	.1338		73	7.3		.2874
35	.1	.1378		74	7.4		.2913
36	.1	.1417		75	7.5		.2953
37	.1	.1456		76	7.6		.2992
38	.1	.1496		77	7.7		.3031
39	.1	.1535		78	7.8		.3071
				79	7.9		.3110
				80	8.0		.3150

Made in U.S.A.

HERE IS A REVOLUTIONARY CONCEPT IN TOOLING, ORIGINATING IN HIGH PRODUCTION SHOPS, BUT MINIATURIZED FOR SMALL LATHES AND MILLS

INSERTS ARE PREFORMED INTO SPECIAL SHAPES FOR TURNING, FACING, BORING, FLY CUTTING, AND CUTTING OFF OPERATION.

New QUICK-SHARPENING INSERTS

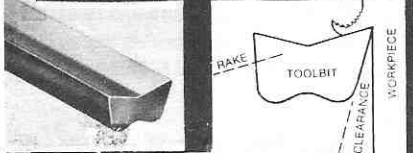

TOP RAKE REDUCES PRESSURE - HEAT

FIT LOW-COST TURNING TOOLS, BORING BARS, FLY CUTTERS

These new inserts fit interchangeably in a complete system of cutting tools designed for lathes to 14" swing. The system includes right- and left-hand turning tools, boring bars, and even insert-type fly cutters for milling flats in lathes or vertical mills.

UP TO 50 SHARPENINGS

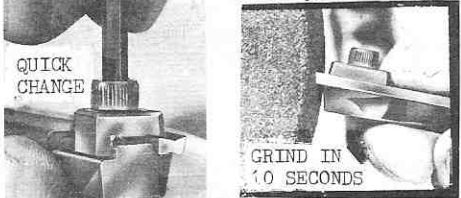

QUICK CHANGE

GRIND IN 10 SECONDS

AVAILABLE IN CARBIDE, T-15 HSS OR M-2 HSS

Inserts are supplied in three cutting tool materials: solid carbide for production operations, premium-quality T-15 high speed steel, or low-cost M-2 high speed steel for general use. This selection of insert types gives the tools in the system ultimate versatility.

SETS 2790S - 2791S

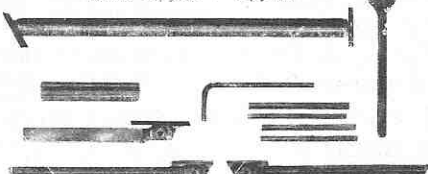

COMPLETE SETS BEAUTIFULLY BOXED

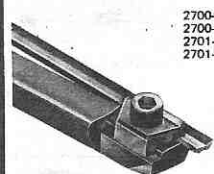

R.H. TOOL HOLDER

2700-R 1/4" R/H Tool holder
2700-L 1/4" L/H Tool holder
2701-R 5/16" R/H Tool holder
2701-L 5/16" L/H Tool holder

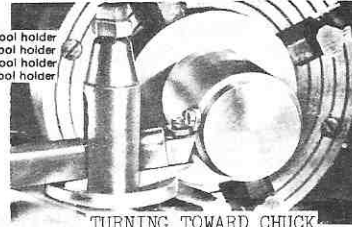

TURNING TOWARD CHUCK



FACING WORKPIECE

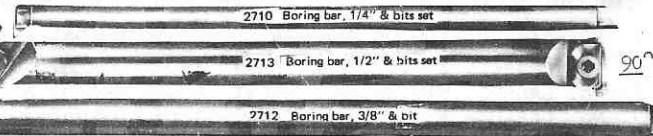
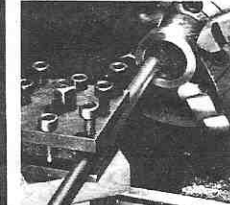

BORING BARS

REPLACEMENT BITS AND V-BLOCKS AVAILABLE - SEE ABOVE PRICE LIST.

2710 Boring bar, 1/4" & bits set

2713 Boring bar, 1/2" & bits set

2712 Boring bar, 3/8" & bit

FOR USE IN LATHES AND MILLS UP TO 2-HP

WITH 1/2"-DIAM. SHANKS FITTING STANDARD HOLDERS

These Edelstaal fly cutters, cutting a 1"-diam. circle hold the same quick-sharpening inserts as the turning tools and boring bars. Hardened bridge clamps grip the inserts with a 25° lead angle for smooth entry into the work. The cutters have hardened 1/2"-diam. shanks that fit standard end mill holders, or they can simply be chucked. While these fly cutters may be used in lathe spindles, they are designed primarily for use in vertical mills. Use them in place of far more expensive end mills for roughing and finishing flats.

WITH 1/2"-DIAM. SHANKS

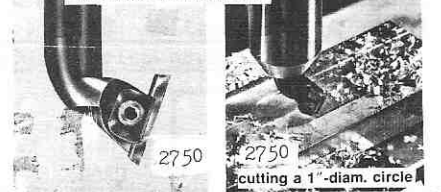

2750

cutting a 1"-diam. circle

CUTOFF OR SLOTTING TOOL

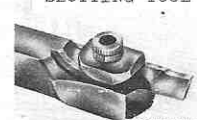

2760

• SMALLEST PARTING TOOL AVAILABLE
• USES SPECIAL 1/16" X 1/4" HSS BLADE

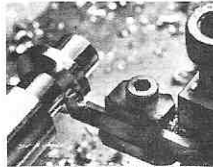

CUT-OFF HOLDER WITH BLADE

No. 2760

REPLACEMENT CUT-OFF BLADE

Wt. 1/2 oz.

No. 2761

The Edelstaal cut-off tool, which has a 5/16"-square shank and holds a special 1/16" x 1/4" T-15 high speed steel parting blade, comes in only one size. The smallest cut-off tool available, it was designed especially for cutting off small work in screw machines, and it is also widely used for parting small precision work in bench lathes. Replacement blades, which are 1-1/2" long, are available.

SPECIAL ACCESSORIES AND SUPPLIES DESIGNED FOR THE UNIMAT SL, UNIMAT 3, AND OTHER MACHINES

8-83

Campbell Tools Co.
PRECISION TOOLS - SHOP SUPPLIES
2100 Selma Road
Springfield, Ohio 45505
(513) 322-8562

KNURLING TOOL 5/8" diameter with 3/8" square shank, H.S. knurl, .100" wide. This narrow knurl requires less pressure while forming deep, well shaped pattern. Knurl can be moved laterally for wider knurl.

CA1 STRAIGHT KNURL HOLDER \$12.95 Ea Wt 2 oz.

CA2 DIAMOND KNURL HOLDER \$14.95 Ea Wt 2

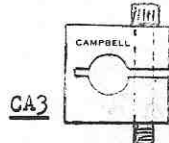
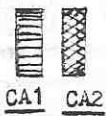

BORING BAR HOLDER Interchangeable with standard Unimat toolpost, but bored to hold 3/8" shank boring bars. Aluminum body. Locking bolt 6 x 30mm furnished complete. CA3 \$6.95 wt 4 oz.

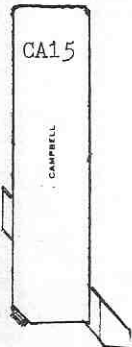

ADJUSTABLE FLY CUTTER designed for use in vertical endmill holders for roughing or finishing flats on metal pieces. Sweeps 5/8" to 1 1/2" circle. Preground 3/16" square bit can be resharpened. 1/2" shank may also be gripped in lathe or drill chuck. With bit and wrench. CA 15 \$9.95 wt 3 oz.

1/2" diameter bar holds 90° bit which can be ground to cut gear teeth by sharpening to fit a sample gear tooth. Holder can be held in CA5, or 3 jaw chuck. CA15a with blank and wrench \$9.95

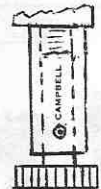

CA5

CA5a



We have added an endmill holder threaded 14 x 1 to fit the Unimat 3 spindle.

1/2" ENDMILL AND KEYSEAT HOLDER is threaded to fit Unimat spindle for horizontal or vertical milling or machining operations. Also adapts our Fly Cutters and Dovetail Cutters to the Unimat. Dovetails require 3/8 to 1/2 sleeve.

No. CA5.....\$14.95 EA...Sh.Wt. 5 oz. UNIMAT SL

No. CA5a....\$ 4.50 EA...Sh Wt 1 oz. UNIMAT SL

No. CA5-U3 \$19.95 EA...Sh Wt 5 oz. UNIMAT 3

No. CA5-U3a \$ 4.50 EA...Sh Wt 1 oz. UNIMAT 3

MILLING TABLE RAISING BLOCK 1/2" thick, raises milling table, so table can pass over crossfeed handwheel, giving more room for milling or indexing. Two 6 x 25 mm, bolts included.

No. CA6..(predrilled) \$5.95 ...WT. 6 oz..(Alum.)
No. CA6a.(blank, no bolts) \$4.00.WT. 6 oz.(2x3 1/2 x 1 1/2)

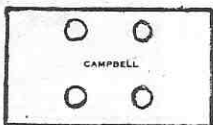

CA6

CA6a

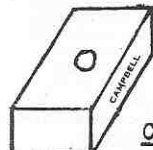

CA7

TOOLPOST RAISING BLOCK Same thickness as 1311 (131.100) Intermediate Piece, raises cutting tools to center of raised spindle. 6mm x 50mm bolt included. No. CA7.....\$5.95 ea. 2 oz.

#1240-1 LONG GRINDING AND SAW ARBOR 45mm (1-5/8") long. Threaded 12 x 1mm at both ends.
No. 124.500.....Ea. \$12.00...Wt. 6 oz.

TAILSTOCK RAISING BLOCK raises tailstock spindle of Unimat SL to level of headstock spindle when Raising Block No. 131.100 (1311) is used.
CA8...\$12.95 3 oz Includes 6 x 50mm bolt.
Two 6 x 35 bolts permit use of CA8 riser with 104.000 (1040) Steady Rest. Set of 2 \$0.60 CA8a

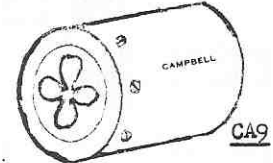
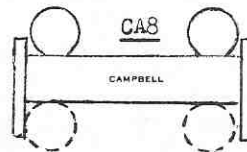

ALUMINUM DIE HOLDER for 5/8" dia. threading die is machined for slip fit on tailstock spindle. Die holder is kept from turning by the hand, while spindle turns, pulling holder forward to required depth of thread. When holder is released, it will turn with thread till spindle is stopped. No. CA9 \$5.95 Ea.....1 oz.
For 13/16" Die.....No. CA9a 7.95 Ea.....2 oz.

SET OF 4 ALUMINUM DOGS 1/4", 1/2", 3/4", 1" with non-marring Aluminum setscrews. Balanced for high speed without vibration. Light duty.

No. CA10 \$13.95 Each Set of 4.....Wt. 4 oz.

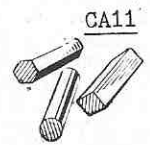
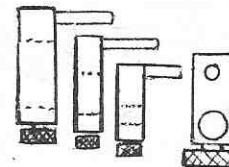
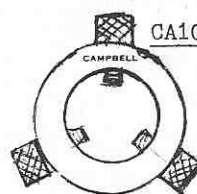

SELECTION SHORT PIECES METAL 1/8" to 3/4" dia. 2" maximum length, mix of steel, some aluminum. brass, approx. 10 pieces. State preference.
CA11..\$2.50 Wt. 8 oz.... CA11b..All brass \$3.50

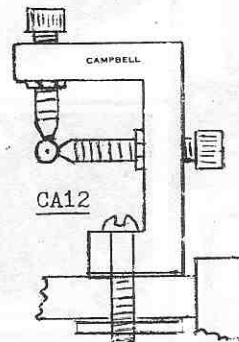

FOLLOW REST FOR SL LATHE. Dual support for slender rods of wood or metal small as 1/16" diameter up to 3/4". Can be set to lead or follow cutting tool. Fastens to cross slide bars.

CA12-SL Wt 3 Oz \$14.95

FOLLOW REST FOR UNIMAT 3
CA12-U3 Wt 4 Oz \$19.95

HAND CRANK permits slow rotation of Compact 5 or Unimat 3 spindle for precision tapping when tap is held in tailstock. Certain special threads can also be chased by hand when they end close to a shoulder, or when chasing internal threads. Aluminum crank locks in rear bore of spindle.

CA5H Crank for Compact 5 Sh Wt 4 oz. \$15.00

CA3H Crank for Unimat 3 Sh Wt 3 oz. \$12.00

GRINDING WHEEL ADAPTOR was original equipment with SL Unimat. Can be machined to hold small saws as well as grinding wheels. No. A2A.090.000 \$19.80

#63 DEAD CENTER \$2.80 Ea. Wt.1oz. GREASE \$1.25 4 oz.

SOCKET HEAD CAP SCREWS all 6mm dia. x 12, 15, 20.....
.20¢ ea..... Or 6/\$1.00





25, 30, 35mm....25¢ Ea.....6 x 50mm....35¢ Ea.

Tools for UNIMAT SL and UNIMAT 3

CAMPBELL TOOLS COMPANY

2100 Selma Rd. Springfield, Ohio 45505

(513) 322-8562

Order Number	TOOLS	WTS.	List Price
111.500 (2820)	6-piece lathe tool bit set $\frac{1}{4}$ square	8oz.	\$ 39.00
111.600	2-piece thread cutting tool bit set	3oz.	12.00
110.010	5-piece lathe tool bit set, unground	7oz.	12.50
119.000	8-piece drilling and milling tool set	4oz.	25.00
152.100	34-piece tool assortment	1lb.	135.00
	Circular saw blades		
123.100	dia 2.4" for metal	1oz.	16.50
123.200	dia 2.4" for wood	1oz.	16.50
152.140	dia 3.2" for wood	2oz.	16.50
117.000 to (1085	Fret saw blades (one dozen)	4oz.	
117.500 to 1087)	117.000 for wood, fine		4.00
	117.200 for metal, fine		7.00
	117.500 for wood, coarse		4.00
118.005 to	Jig saw blades (set of 5)	1oz.	
118.205	118.005 (for wood)	Specify type	9.75
	118.105 (for plastics)		9.75
	118.205 (for metal)		9.75
119.500	Circular wire brushes (set of two)	2oz.	10.00
119.300 (1034)	Felt polishing discs (set of three)	3oz.	6.50
119.100 (2841)	Grinding wheels (set of three)	6oz.	15.00
116.000 (2821)	Dressing tool (Diamond Point)	3oz.	20.00
112.500 to	Sanding discs (one dozen)	2oz.	
112.700	112.500 grit 100		2.50
	112.600 grit 80 Price per dozen;		2.50
	112.700 grit 60 Specify grit		2.50
112.900	Adhesive for sanding discs	4oz.	4.50
116.600	Polishing lambskin	2oz.	5.00
119.200	Wood turning tools (set of three)	6oz.	17.50
111.400 (2827)	Center drill 	$\frac{1}{4}$ oz.	4.00
764.302	End mill cutter 	1oz.	12.00
113.100 (2834)	Slotting cutter 	1oz.	12.00
113.200 (2828)	Countersink bit 	1oz.	7.00
152.090	Grinding wheel (for UNIMAT 3 only)	2oz.	5.00



6 assorted tools bits,
ground
Order no. 111 500
5 tool bits, unground
Order no. 110 010

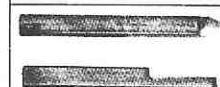

2 thread-cutting tools
(external and internal
threadcutting tool)
Order no. 111 600

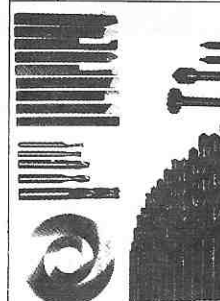

Tool set, large:
15 twist drills, 1-8 mm dia.
in steps of 0.5 mm;
2 centre drills, 1.5 mm dia.;
4 T-slot cutters,
3, 4, 5, 6 mm dia.;
1 roughing tool, 8 mm dia.;
8 assorted ground turning
tools; 1 turning tool,
unground; 1 circular saw
blade, dia. 60 mm;
1 countersink bit 90°;
1 two-flute cutter,
16 x 4 mm dia.
Order no. 152 100

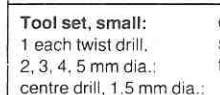

Tool set, small:
1 each twist drill,
2, 3, 4, 5 mm dia.;
centre drill, 1.5 mm dia.;
countersink bit 90°;
slot cutter, 4 mm dia.;
two-flute cutter, 16 x 4 mm dia.
Order no. 119 000



Circular saw blade
for metal, 60 mm dia.
Order no. 123 100



2 circular brushes
brass and steel wire
Order no. 119 500

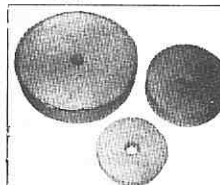

3 felt discs
40 x 8, 50 x 10,
70 x 15 mm dia.
Order no. 119 300



Grinding wheel
for tool grinding
attachment
Order no. 152 090



Truing diamond
for grinding wheel
Order no. 116 000

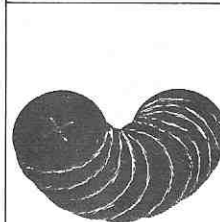

Doz. sanding discs
for rubber disc, 125 mm
dia., grit 120
Order no. 116 700
ditto, grit 80
Order no. 116 800
ditto, grit 50
Order no. 116 900

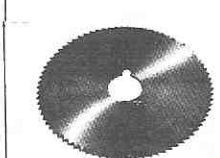

Circular saw blades
for wood, 80 mm dia.
Order no. 152 140
Order no. 123 200



Doz. sanding discs
for sanding wheel,
90 mm dia., grit 100
Order no. 112 500
ditto, grit 80
Order no. 112 600
ditto, grit 60
Order no. 112 700
Adhesive
for sanding discs,
tin 100 g
Order no. 112 900

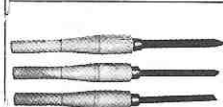

3 assorted wood
turning tools
1 each: wood turning
chisel gouge, wood turning
chisel skew, parting off tool
Order no. 119 200



Polishing lambskin mop
for rubber disc
Order no. 116 600

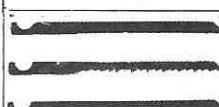

Set of 5 jig saw blades for wood
Order no. 118 005
Set of 5 jig saw blades for plastic
Order no. 118 105
Set of 5 jig saw blades for metal
Order no. 118 205

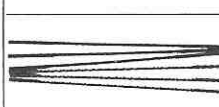

Set of fret saw blades,
for wood
1 doz. each coarse,
medium, fine
Order no. 117 510
Doz. fret saw blades
for metal, fine
Order no. 117 200